

50Hz
DSWQ Series

TOTAL PUMP SOLUTION

SAVING ENERGY
Pump Solution For Better Future

Submersible Sewage Pump



DOOCH CO., LTD.

NO.239 ZhangLiantang Road, Liantang Industrial Park, Qingpu District, Shanghai City, China

Service Hotline : 400-622-6271



The Pioneer of Digital Integrated Full Frequency Control pump system



021- 67679390



021- 67679396



www.doochpump.com.cn



www.doochpump.com.cn

上海中韩杜科泵业制造有限公司
SHANGHAI SINO-KOREA DOOCH PUMP MFG CO., LTD.

Submersible Sewage Pump

Contents



01-22 DSWQ (JY) series Submersible Sewage Pump

23-36 DSF series Submersible Sewage Pump

37-40 DS-F series All Stainless Steel Submersible Sewage Pump

41-48 DSWQ-QX series Anti-Winding Cutting Submersible Pump

49-50 DSAS series Cutting Type Submersible Sewage Pump



Product Description

In order to make the DSWQ (JY) series of submersible sewage pumps serve customers with better reliability and higher unit efficiency, we have updated the optimized hydraulic model again based on the 25 years of experiences in manufacturing the series of pumps. Innovative mechanical seal bearing structure, using high-quality motor materials, according to the use of environmental conditions, 18.5kW and above pump cycle cooling motor to ensure reliability. The full range of 122 basic specifications, with prototype impellers and modified impellers and their cutting, in the spectral performance range, can provide the pump that meets the user's needs for any flow rate and head point. Products standard based on GB/T24674-2009.

- The unit's unique cooling system enables the pump to operate safely and reliably when exposed to liquid or dry installation (15kW and below pumps without cooling system), to maximize the discharge of sewage, pump side tungsten carbide to silicon carbide friction pair, high temperature resistance, resistance Impact, wear resistance, motor side silicon carbide graphite friction, low friction
- Lifetime Lubrication Maintenance-free rolling bearings withstand all axial and radial forces and are completely separate from the pumping medium transferred.

Scope of Application

It is mainly used in municipal engineering, building construction, hospitals, hotels, industrial sewage and sewage treatment industries. It is used to transport wastewater, sewage and rainwater with solid particles and long fibers, as well as raw water transportation, aquaculture and irrigation etc.

Conditions of Usage

- The impeller adopts double flow passage, which matches the pump body, the flow passage is wide, and the dirt property passing is good;
- The pump unit is compact in structure, short in shaft extension, reducing vibration and noise, and prolonging the life of the machine seal and bearing;
- The cable is a heavy-duty rubber sleeve flexible cable with excellent oil-resistant sewage and excellent mechanical properties. It can work continuously for a long time at an ambient temperature of 40 °C.
- The watertight cable prevents accidental water leakage and causes the motor cavity to enter the water. The pump end cable is properly fixed to prevent the cable from the motor cover cable leading-out device.
- High-performance squirrel cage induction motor for pumps, protection class IP68, B or F, Class H insulation, overheating and overcurrent protection components for each phase winding.

- The medium temperature does not exceed 40 °C, the volume ratio of solid phase in the medium is less than 2%, and the medium PH=4~10
- Minimum operating level: See ▽ in the installation dimension drawing (no motor cooling system). When there is motor cooling system, the water level only needs to ensure the pump can deliver water normally.
- The main parts of the pump are cast iron or ductile iron.
- The maximum particle diameter of the solids in the medium is less than the value of the performance parameter table d50, and the length of the fibers in the medium is smaller than the diameter of the discharge side of the pump.

Technical Description

1、Product model and Definition

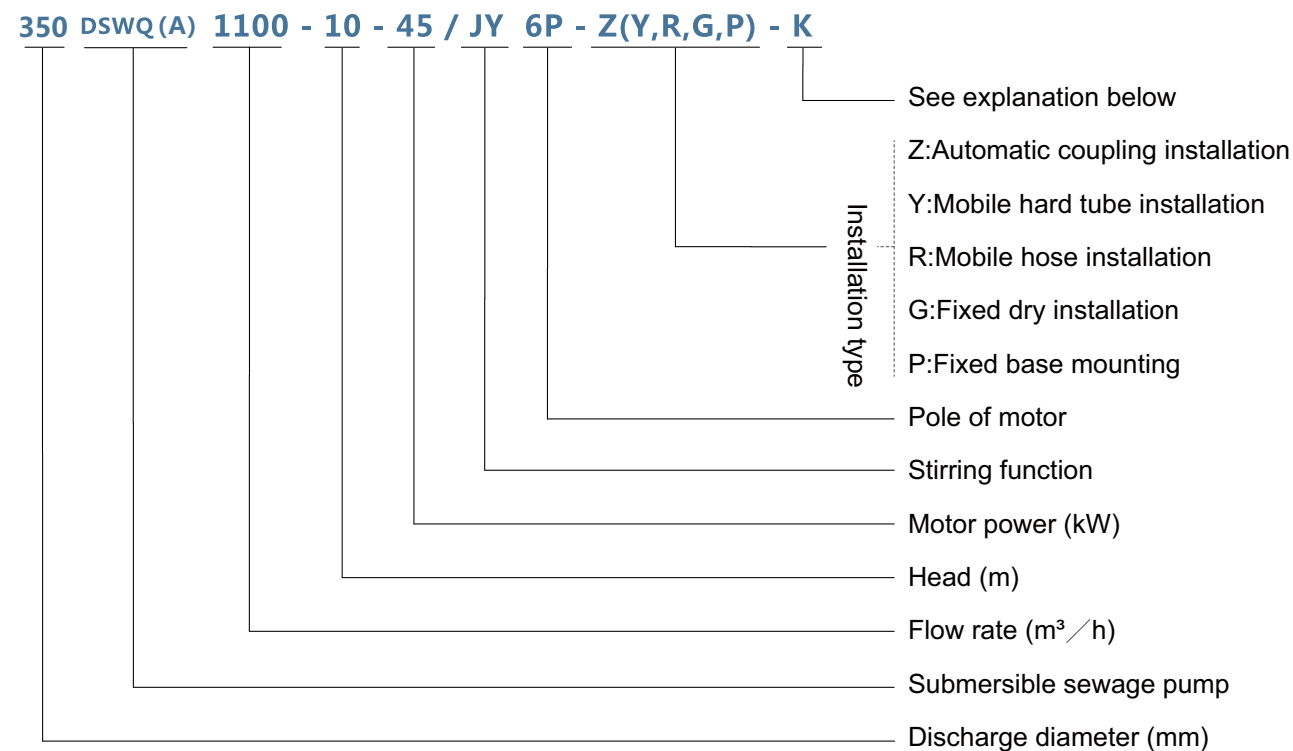

When the letter is not marked, it indicates the Δ connection method in the wiring cavity of the motor winding; when the standard K is indicated, the 6 wires of the motor winding are directly led out.

2、 The rated voltage of the submersible pump motor is 380V, and the rated frequency is 50Hz.

- ① We can produce single-phase 220V submersible sewage pump with power of 0.55~2.2kW
- ② According to the customer needs electric pump unit frequency can be customized 60Hz
- ③ Electric pump units with three-phase voltages below 690V can be manufactured.

3、 Connection and starting method of motor winding lead wire:

- ① 3kW and below motor windings are directly activated by Y-connection method;
- ② 4~11kW, 132kW and above motor winding by Δ wiring method, 4kW~11kW direct start; 132kW and above direct start, auto-coupled buck start or external electronic soft starter.

③ When the 6~10kW motor windings are directly led out, press Y- Δ to start or the internal electronic soft starter to started. When the Δ connection is used, the auto-reduction step-down or external electronic soft starter to started;

④ The 0.55~2.2kW220V single-phase electric pump has Capacitor and Dual-capacitor+Centrifugal switch modes for starting

4、 The submersible sewage pump is equipped with various protection devices for protecting the motor. The electric control cabinet must be matched with these protection devices. The electric control cabinet should also be equipped with a float switch for liquid level control, so the electric control cabinet of the submersible sewage pump has special character.

① 3kW and below electric pump each phase winding has overheating and overcurrent protection components, equipped with automatic reset thermal switch automatic start and stop group, with air switch; can also be configured according to customer requirements

② The electric pump is equipped with a leaking water and oil-water normal- open probe, and the PTC of the temperature measuring component is embedded in each phase winding, and is provided according to customer requirements;

③ Electric pump lower bearing configuration temperature measuring component PT100, according to customer requirements

5、 Whether the motor has a cooling system corresponding to different minimum liquid level values; the liquid level float switch is used when the electric control cabinet is placed in the automatic gear; the liquid level difference between the start and stop pumps is large, and two for the main pump or the large pump The float switch controls the start and stop liquid level; for a small pump or a super pump with an ultra-high liquid level, a float switch is used to control the start and stop liquid level;

6、 When the electric control cabinet is far away, the terminal box can be set. When the threading pipe (user-supplied) is required, the inner diameter of the threading pipe is determined according to the outer diameter of the cable;

7、 Viewed from the pump suction port, the impeller rotates counterclockwise;

8、 The coupling flange of the coupling seat is in accordance with GB17241.6. The nominal pressure is PN6 with diameter ≤ 250 , PN10 with diameter ≥ 300 , and the outlet flange of stainless steel coupling seat is PN10. Cone and elbow are in accordance with customer requirements.

Product Structure

Structure 1 0.55~7.5kW

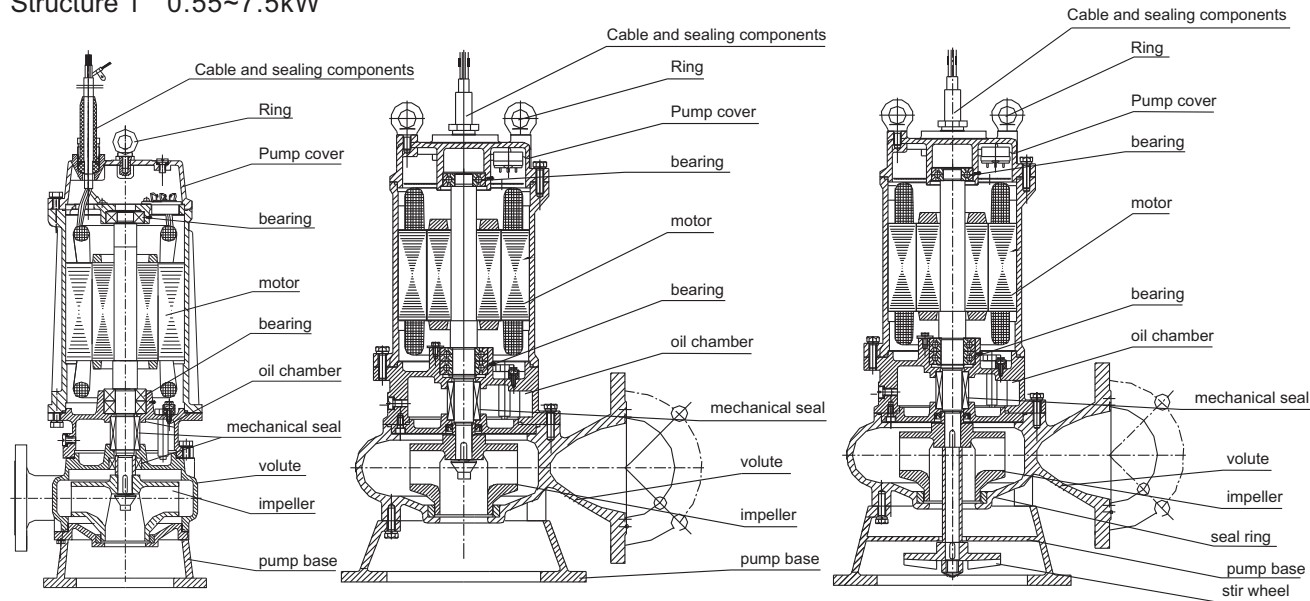

Structure 2 1kW、DSWQA45kW-6P and above submersible pump drawing

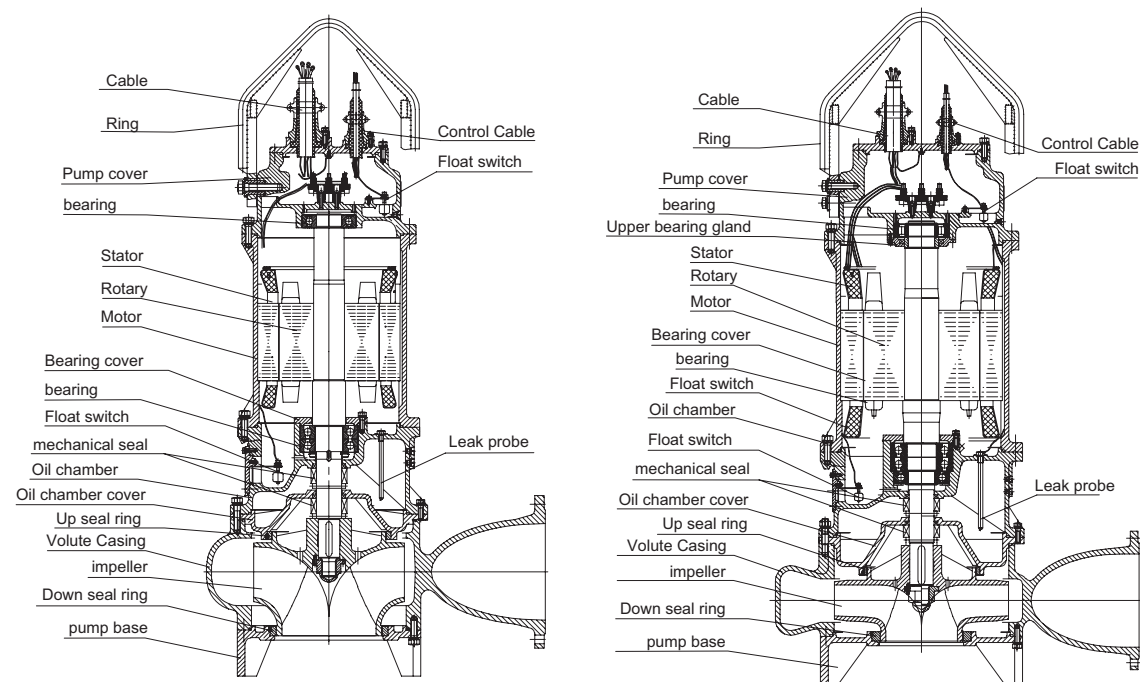

Material Configuration of Main Parts

Parts	Volute Casing- Impeller- Base	Motor Cover	Shaft	Mechanical Seal Components			
				Motor side friction pair	Pump side friction pair	Spring	Rubber components
Materials	Standard configuration HT200	HT200	20Cr13	SiC / Graphite	TC / SiC SiC / SiC	Stainless	Nitrile rubber (NBR) Fluoro rubber(FKM) as option
	Optional HT250/ QT400-18/QT450-10						

Installation Method

1. Automatic coupling installation (Z) : The coupling device includes a guide rod, a guide rod frame, an outlet pipe seat and a coupling frame, and the pump and the pipe are connected, and the connection and disengagement of the pump and the pipe are made simple and easy without using the fastener; the pump of the same discharge port diameter can use the same Coupling device, see Figure 1
2. Fixed dry type installation (G) : The pump room and the sump are separate. The motor must have a cooling system. If the pump room is flooded, the pump runs normally. See Figure 2.
3. Fixed base type installation It is inconvenient to repair after the pump is running. If the pipeline is sufficiently rigid, the anchor bolts may not be installed. See Figure 3.
4. Mobile type installation (Y、R) : For emergency or repair, construction needs, the base can be connected to the hose or pipe to run, or the rigid drainage pipe can be used to suspend the pump, see Figure 4.

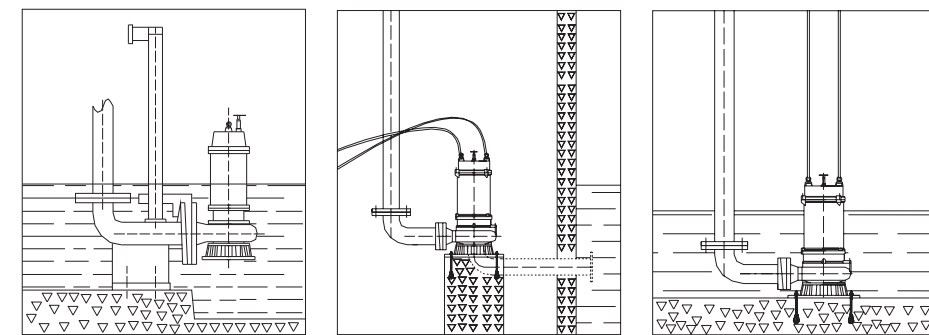

Figure 1 Figure 2 Figure 3

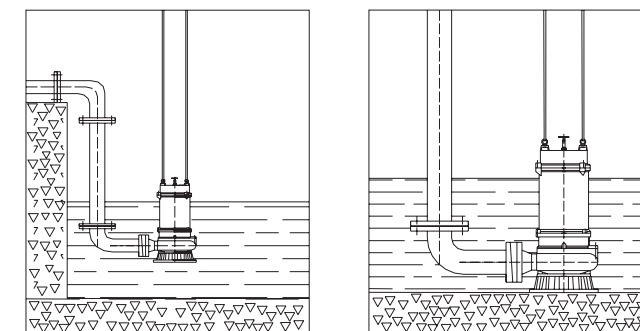
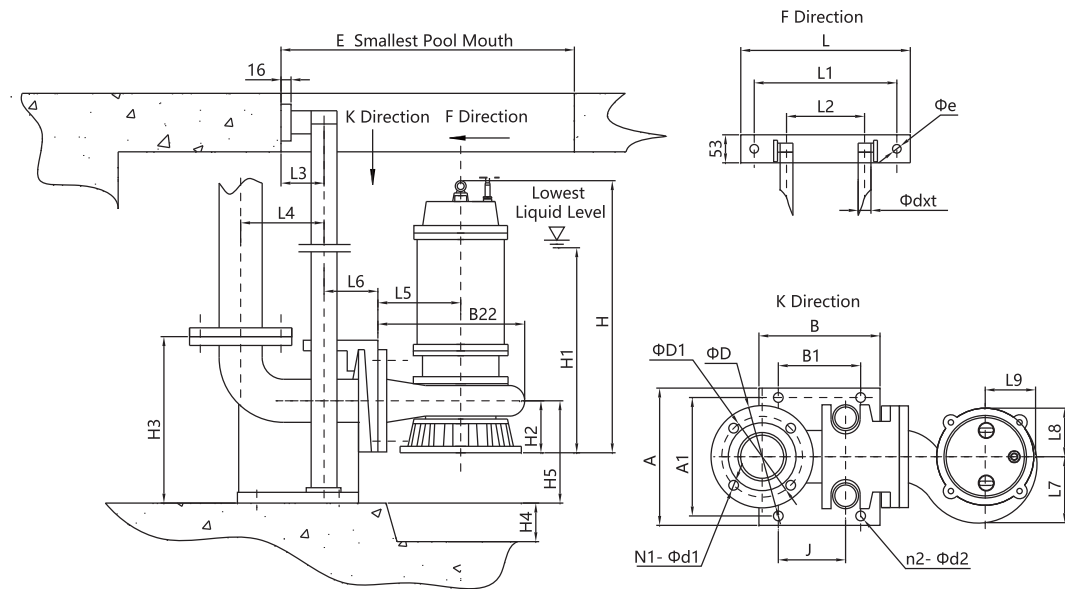
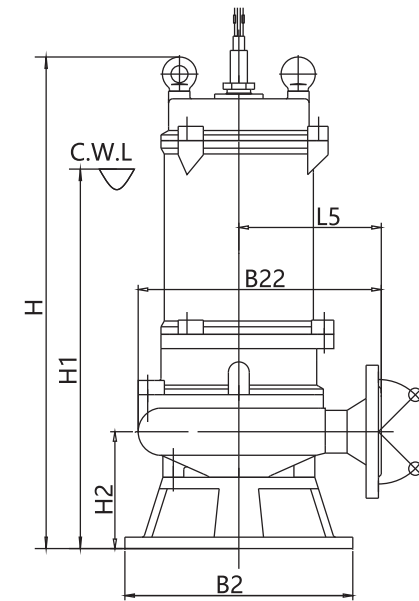

Figure 4

DSWQ(JY) Pump Dimension and Mobile Type Installation Drawing



DSWQ(JY) Pump dimension and mobile type installation drawing



Hard tube mobile type installation

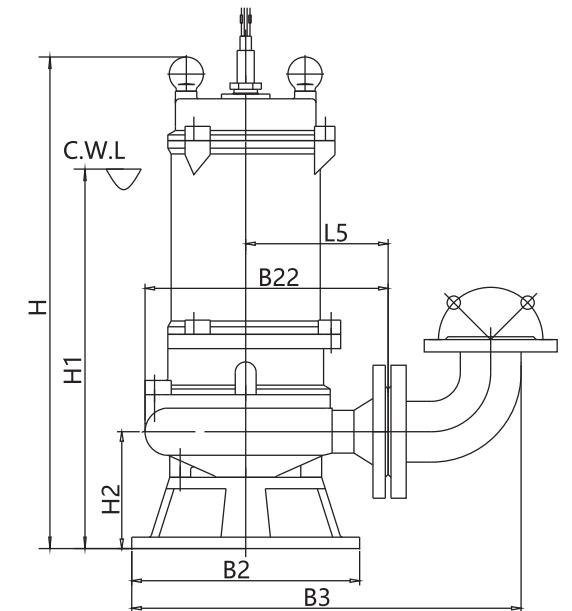

Hard tube (with double flanged elbow) mobile installation

DSWQ(JY) Coupling installation size data sheet(unit: mm)

Model	Flange connection dimension			Coupled base seat size						H3	H4	H5	L	L1	L2	M	Φe	L3	L4	L6	Φdxt
	D	D1	N1-Φd1	A	A1	B	B1	J	n2-Φd2												
40DSWQ	130	100	4-Φ14	108	65	138	68	68	4-Φ18	195	100	120	225	185	70	35	Φ14	65	125	85	Φ34 x 3
50DSWQ	140	110	4-Φ14	197	168	208	130	120	4-Φ18	250	100	165	265	215	110	42	Φ14	66	135	90	Φ34 x 3
65DSWQ	160	130	4-Φ14	238	190	252	155	135	4-Φ16	265	100	170	280	235	125	50	Φ14	70	185	85	Φ34 x 3
80DSWQ	190	150	4-Φ19	255	220	225	153	125	4-Φ18	310	100	190	315	265	145	53	Φ14	80	155	100	Φ34 x 3
100DSWQ	210	170	4-Φ19	293	265	258	175	140	4-Φ25	350	100	235	365	305	170	55	Φ15	100	200	110	Φ48 x 3
150DSWQ	265	225	8-Φ19	400	300	410	300	210	4-Φ25	485	150	305	410	260	285	60	Φ15	100	300	190	Φ48 x 3
200DSWQ	320	280	8-Φ19	400	300	450	350	245	4-Φ25	550	200	330	410	260	285	60	Φ15	100	330	195	Φ48 x 3
250DSWQ	375	335	12-Φ19	460	370	570	430	325	4-Φ25	640	200	350	410	260	285	60	Φ15	100	395	195	Φ48 x 3
300DSWQ	445	400	12-Φ23	550	415	600	465	330	4-Φ25	730	200	415	530	350	375	65	Φ16	115	392	266	Φ60 x 3
350DSWQ	505	460	16-Φ23	650	419	645	400	320	4-Φ25	855	200	480	520	350	375	65	Φ16	115	424	285	Φ60 x 3
400DSWQ	565	515	16-Φ28	630	490	675	520	390	4-Φ25	965	200	560	520	350	196	65	Φ16	145	460	288	Φ60 x 3
450DSWQ	615	565	20-Φ28	600	500	675	520	530	4-Φ40	900	200	470	550	400	250	130	Φ22	130	600	250	Φ75 x 3
500DSWQ	670	620	20-Φ28	650	550	700	600	580	4-Φ40	950	200	490	600	400	300	130	Φ22	130	600	250	Φ75 x 3
600DSWQ	780	725	20-Φ31	1200	1050	1150	1100	1100	4-Φ48	1100	280	590	650	450	350	156	Φ26	150	720	300	Φ75 x 3

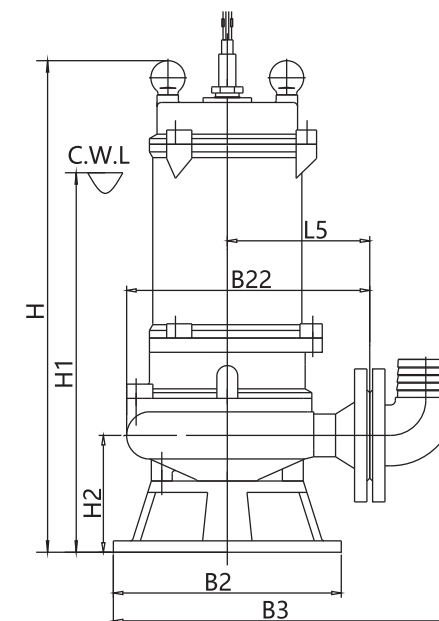

Hose mobile type installation

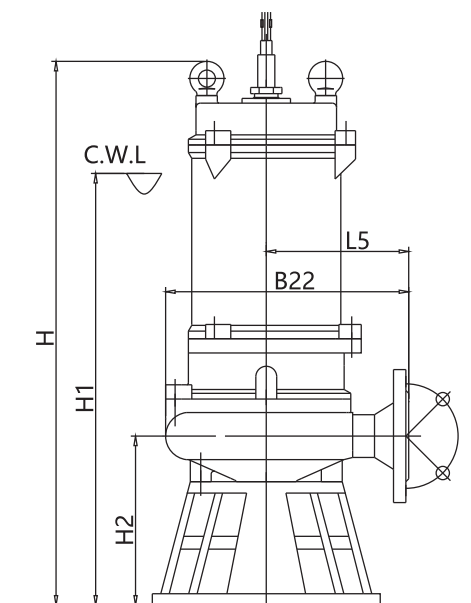

String pump mobile type installation

Order remarks

When place order, please advise:

- 1、 Series code, flow rate, head, speed, motor power, medium temperature, medium composition, medium density;
- 2、 Parts and materials: pump body, pump cover and impeller;
- 3、 Installation method and outlet diameter
- 4、 When need Y-△ start or internal method electronic soft starter to start, note K at the end of the pump model, the order indicates the configuration K motor;
- 5、 Pumps with a discharge diameter of not more than 150 and a motor power not more than 22 kW can be installed R and Y type.
- 6、 Pumps with a discharge diameter not more than 600 can be automatically coupled.
- 7、 For pumps that can be equipped with motor cooling system, indicate whether the motor needs to be equipped with a cooling system and whether it is internal or external connection for motor cooling water.
- 8、 The motor cable provided at 9 meters. Other lengths are required to be indicated when place order;
- 9、 The complete supply parts are provided according to the determined installation method.
- 10、 Options and remarks are ordered separately by the user.
- 11、 When the cone and elbow joints on the discharge line are connected to each other, the principle of “first diffusion and then turning” is followed to minimize the tube loss.

Model Selection Form

S/N	Model:	Motor cavity water leakage detector:	Top	Bottom
1	Flow rate: Q= (m3 h)	Bearing temperature detector:	Top	Bottom
2	Head: H= (m)	Motor coil overheat protection:	Yes	No
3	Depth: h= (m)	Water temperature: Normal	℃ MAX.	℃ MIN.
4	Outlet diameter: mm	Corrosion composition:		
5	Insulation class: B/F/H	Oxide concentration (ppm):		
6	Rated motor power: (kW)	Sediment content: %		
7	Customer site power: (V)	Maximum particle diameter: (mm)		
8	Pump RPM: (r/min)	Fiber type and length: (mm)		
9	Frequency: Hz	Ambient temperature: Normal	℃ MAX.	℃ MIN.
10	Starter type:	Flame retardant requirements:	Yes	No
11	Cutting requirements: Yes No	Cooling requirement:	Yes	No
12	Stirring requirements: Yes No			

Chart for scope of supply

scope of supply	installation method					remarks	
	Wet type installation				Fixed dry type installation		
	Fixed type installation		mobile type installation		Base type installation P11kW and above		
	Automatic coupling type installation Z	Base type installation P11kW and above	The outlet diameter is not more than 150 and the motor power is ≤22Kw				
		Soft connector R	hard connector Y				
Complete standard supply	pump	○	○	○	○		
	Elbow joint (1pcs/set)				○		
	Hose bending joint (1pcs/set)			○			
	automated coupling device	○					
	(Suction bend 1pcs/set)					○	
	base seat (1pcs/set)		○	○	○	○	
Optional parts	electrical control cabinet	○	○	○	○		
	Elbow joint		○			○	
	Cone tube	○	○		○	○	
	Trash rack	○	○	○	○	○	customization
	start/stop device	○	○	○	○	○	customization
	Rectangular gate	○	○	○	○	○	customization
	terminal box	○	○	○	○	○	
	(liquid) Float switch	○	○	○	○	○	
	gate valve/butterfly valve	○	○	○	○	○	
	check valve	○	○	○	○	○	
	anchor bolt	○	○			○	
	hose			○			
	Stainless steel wire rope and rope clamp for lifting pump	○	○	○	○	○	
	spare part	impeller	○	○	○	○	
		seal ring	○	○	○	○	
bearing		○	○	○	○		
mechanical seal		○	○	○	○		
	O-ring	○	○	○	○		

DSWQ

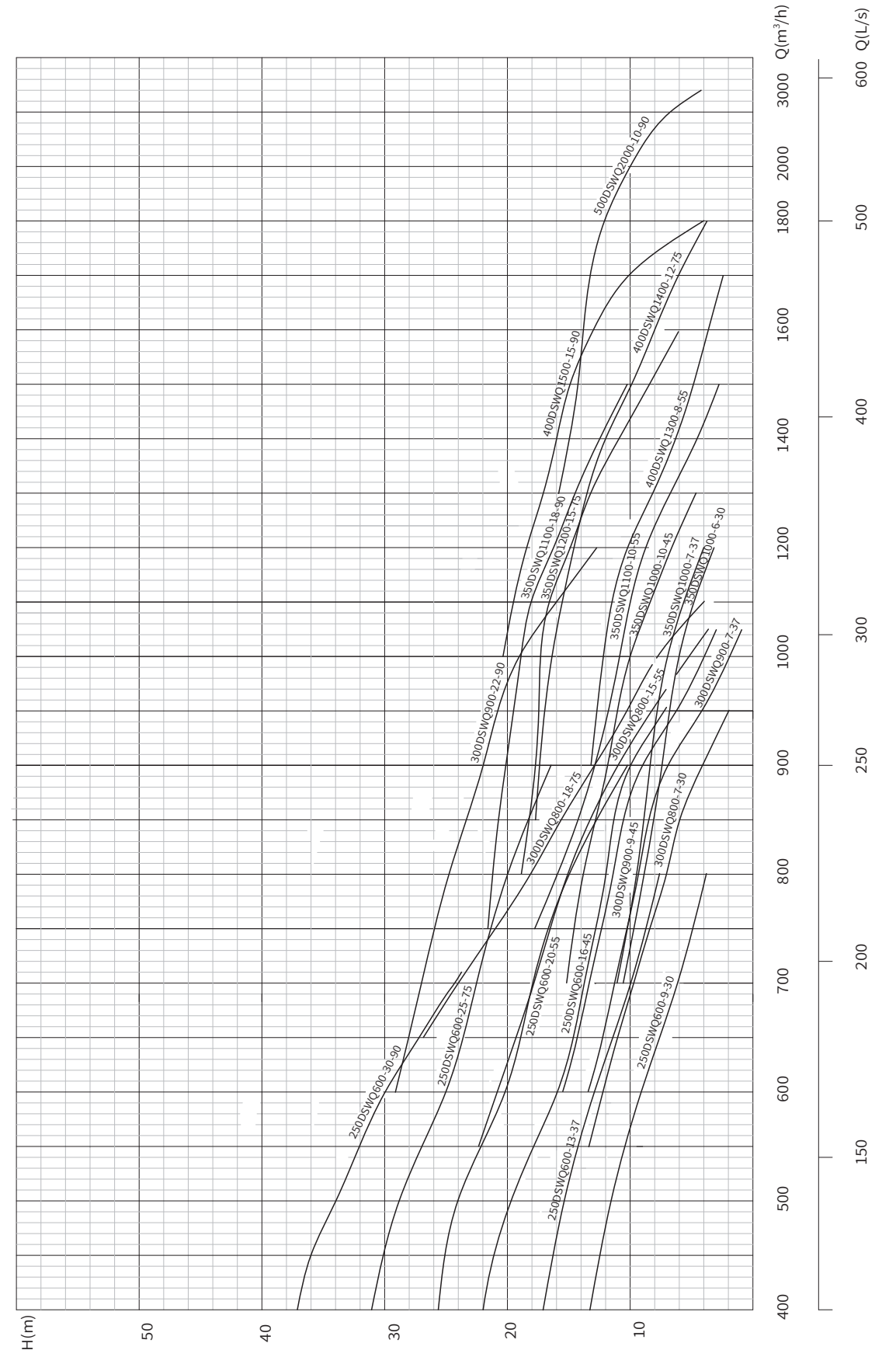
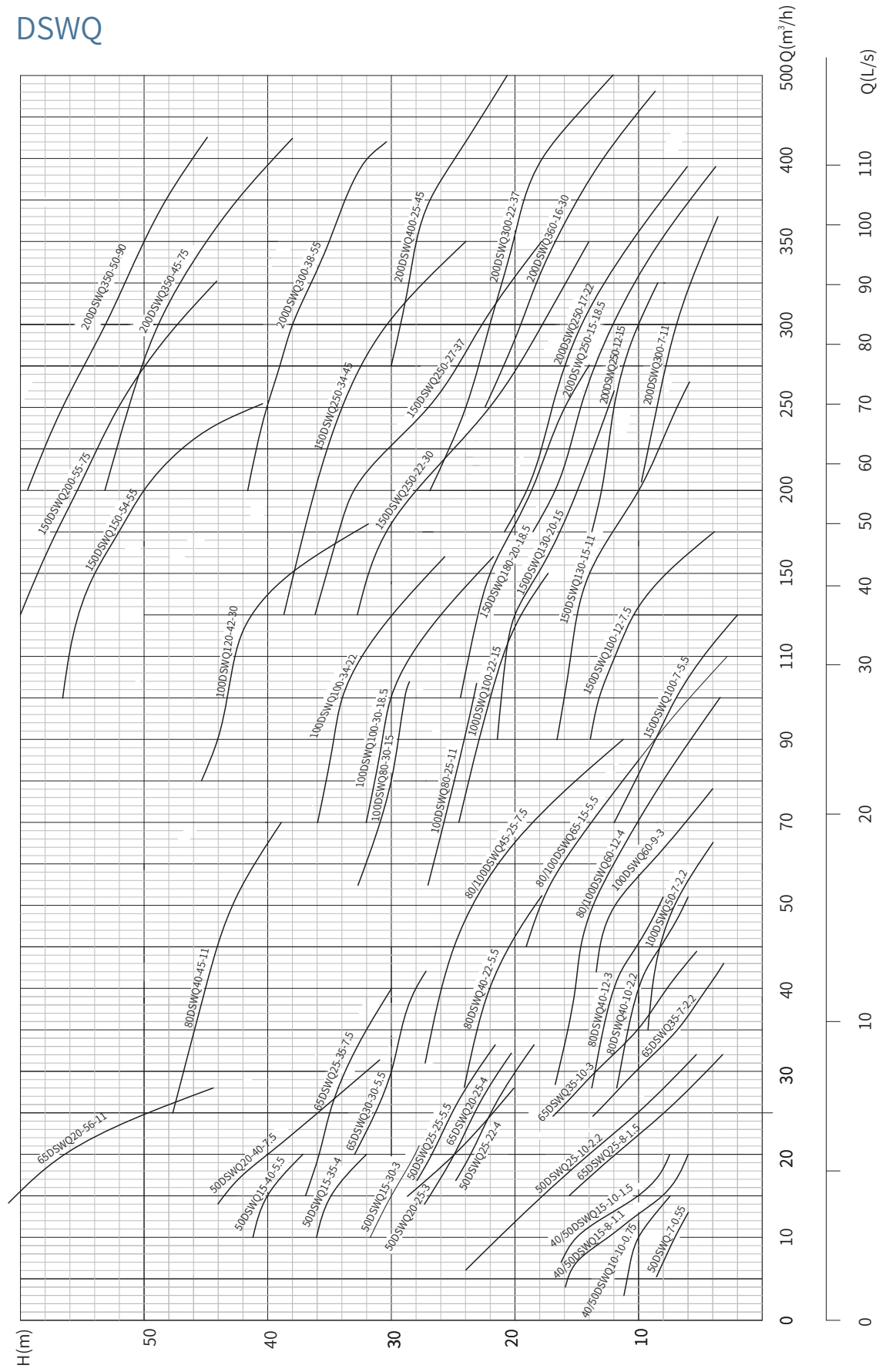

DSWQA

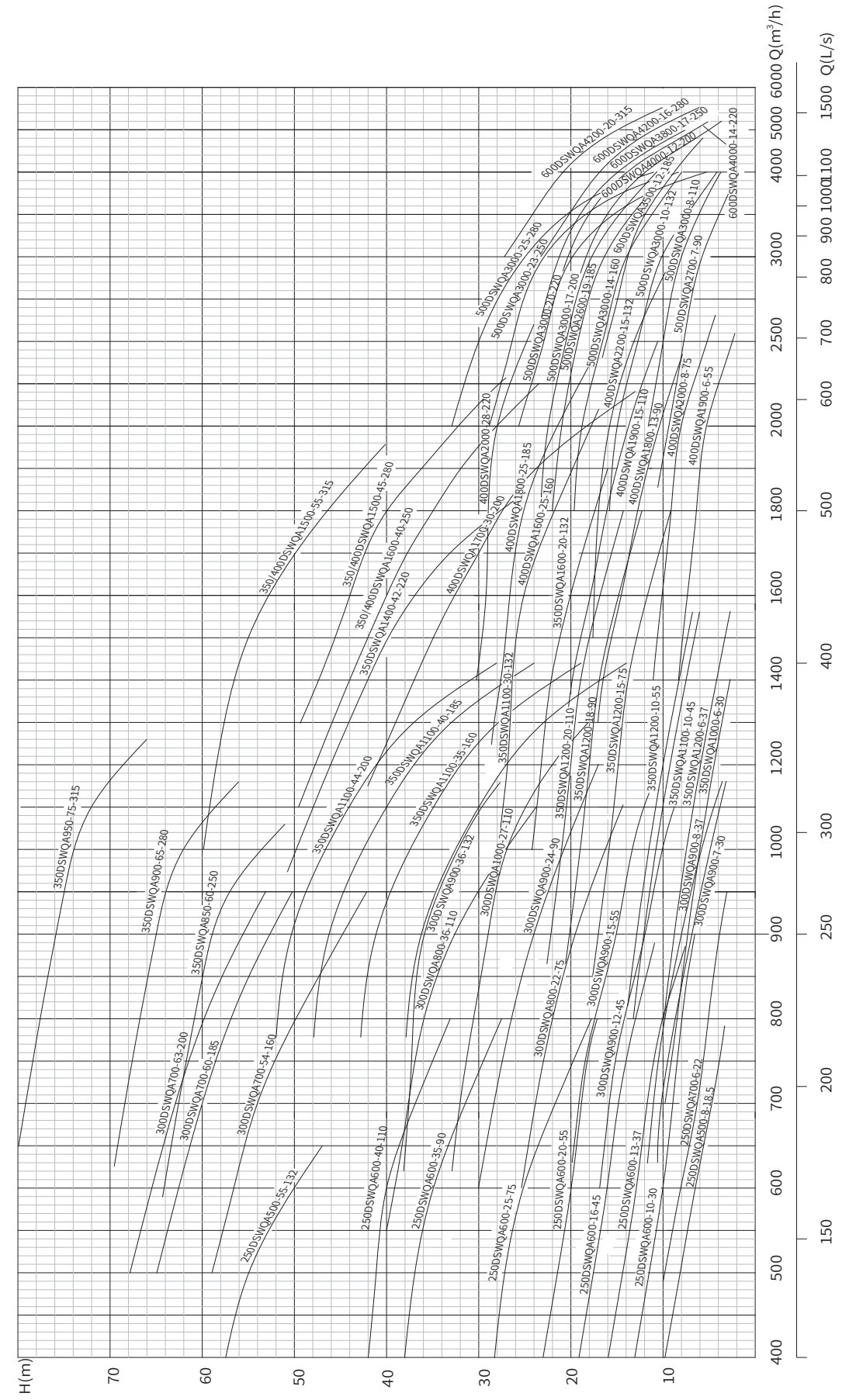
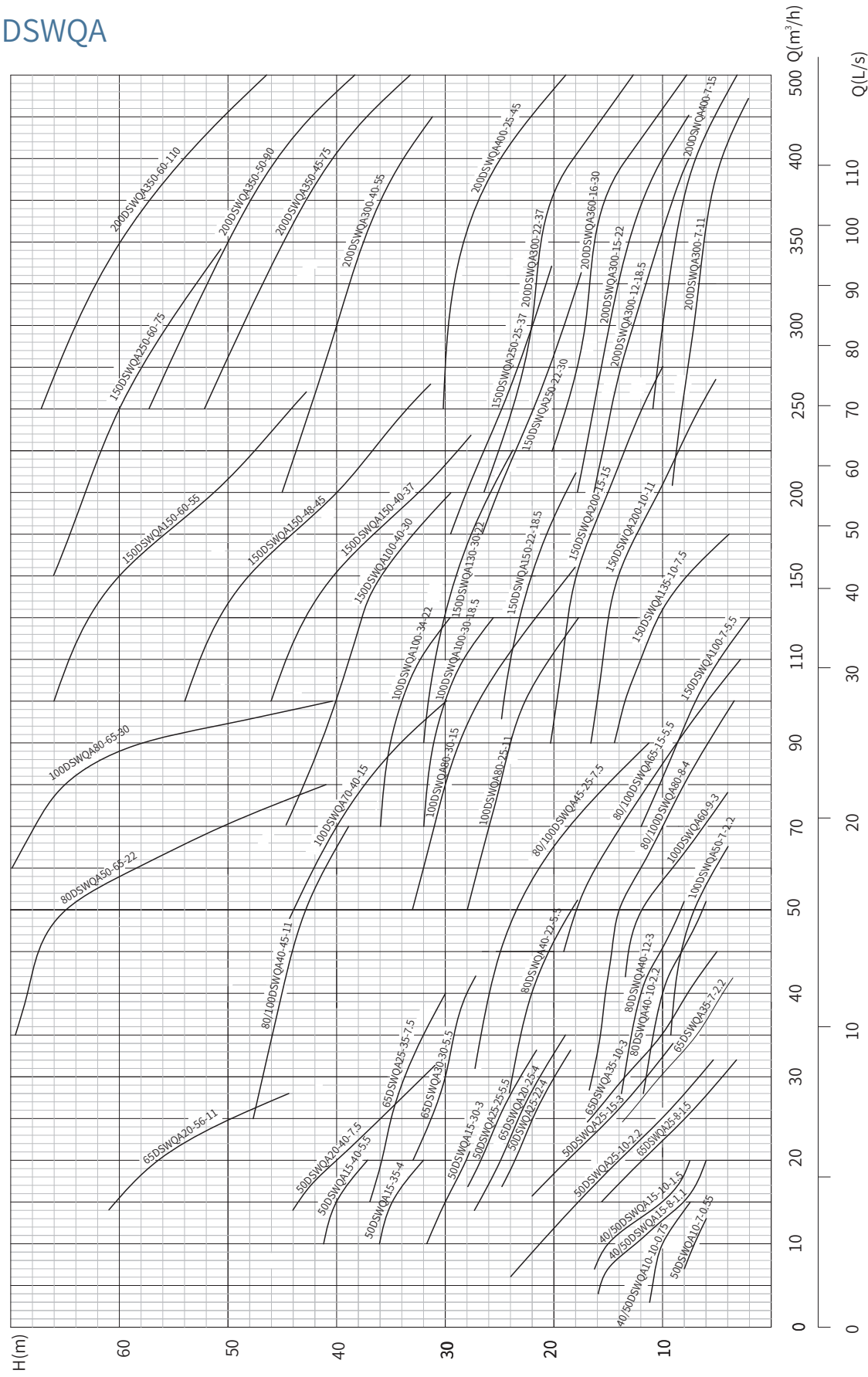

DSWQ(JY)Sewage Submersible Pump Technical Parameters and Dimensions

S/N	Model	Pump Outlet Diameter	Flow Rate Q	Head H	RPM n	Power P	Pump efficiency η	Motor power factor	Motor rated current	the maximum diameter of the particles d50	Dimension (mm)						Weight
		mm	m ³ /h	m	rpm	Kw	%	cosφ	A	mm	H	H1	B3	B22	L5	H2	kg
1	40DSWQ10-10-0.75	40	10	10	2950	0.75	67	0.83	1.83	10	450	380	320	235	140	100	23/26
2	40DSWQ7-15-1.1	40	7	15	2950	1.1	70	0.85	2.60	10	490	380	320	235	140	100	25
3	40DSWQ15-8-1.1	40	15	8	2950	1.1	70	0.85	2.60	10	490	380	320	235	140	100	25
4	40DSWQ12-15-1.5/JY	40	12	15	2950	1.5	73	0.84	3.50	15	490	420	360	270	140	120	29
5	50DSWQ10-7-0.55	50	10	7	2950	0.55	67	0.83	1.33	10	450	380	320	235	140	110	23/26
6	50DSWQ10-10-0.75	50	10	10	2950	0.75	67	0.83	1.83	10	450	380	320	235	140	110	23/26
7	50DSWQ7-15-1.1(非法)	50	7	15	2950	1.1	70	0.85	2.60	10	490	380	320	235	140	110	25
8	50DSWQ7-15-1.1	50	7	15	2950	1.1	70	0.85	2.60	10	490	380	320	235	140	110	25
9	50DSWQ15-8-1.1	50	15	8	2950	1.1	70	0.85	2.60	10	490	380	320	235	140	110	25
10	50DSWQ10-15-1.5/JY	50	10	15	2950	1.5	73	0.84	3.50	15	520	415	370	280	150	120	31
11	50DSWQ15-10-1.5/JY	50	15	10	2950	1.5	73	0.84	3.50	15	520	415	370	280	150	120	31
12	50DSWQ9-22-2.2/JY	50	9	22	2950	2.2	75	0.85	4.90	10	520	450	370	270	150	125	37
13	50DSWQ25-10-2.2/JY	50	25	10	2950	2.2	75	0.85	4.90	10	520	450	370	270	150	125	37
14	65DSWQ25-8-1.5/JY	65	25	8	2950	1.5	73	0.84	3.50	30	525/(568)	455/(498)	395	280	160	125/(168)	38
15	65DSWQ35-7-2.2/JY	65	35	7	2950	2.2	75	0.85	4.90	30	525/(568)	455/(498)	395	280	160	125/(168)	38
16	80DSWQ40-10-2.2/JY	80	40	10	2950	2.2	75	0.85	4.90	30	540/(583)	450/(493)	415	285	165	125/(168)	41
17	100DSWQ50-7-2.2/JY	100	50	7	2950	2.2	75	0.85	4.90	35	542/(583)	472/(513)	460	300	180	140/(181)	41
18	50DSWQ15-30-3/JY	50	15	30	2950	3	77	0.87	6.40	25	550/(593)	480/(523)	380	300	180	125/(168)	43
19	50DSWQ20-25-3/JY	50	20	25	2950	3	77	0.87	6.40	25	550/(593)	480/(523)	380	300	180	125/(168)	43
20	65DSWQ35-10-3/JY	65	35	10	2950	3	77	0.87	6.40	30	545/(588)	475/(518)	395	280	160	125/(168)	42
21	80DSWQ40-12-3/JY	80	40	12	2950	3	77	0.87	6.40	30	540/(583)	470/(513)	415	300	180	125/(168)	43
22	100DSWQ60-9-3/JY	100	60	9	2950	3	77	0.87	6.40	35	562/(605)	492/(535)	460	300	180	140/(183)	62
23	50DSWQ15-35-4/JY	50	15	35	2950	4	78	0.87	8.10	25	580/(615)	500/(535)	395	295	170	132/(167)	61

S/N	Model	Pump Outlet Diameter	Flow Rate Q	Head H	RPM n	Power P	Pump efficiency η	Motor power factor	Motor rated current	the maximum diameter of the particles d50	Dimension (mm)						Weight
		mm	m ³ /h	m	rpm	Kw	%	cosφ	A	mm	H	H1	B3	B22	L5	H2	kg
24	50DSWQ25-22-4/JY	50	25	22	2950	4	78	0.87	8.10	25	580/(615)	500/(535)	395	295	170	132/(167)	61
25	65DSWQ20-25-4/JY	65	20	25	2950	4	78	0.87	8.10	30	580/(615)	500/(535)	430	315	180	132/(167)	60
26	80DSWQ40-15-4/JY	80	40	15	2950	4	78	0.88	8.10	30	600/(635)	520/(555)	440	315	180	140/(175)	61
27	80DSWQ60-12-4/JY	80	60	12	2950	4	78	0.88	8.10	30	600/(635)	520/(555)	440	315	180	140/(175)	61
28	100DSWQ80-8-4/JY	100	80	8	2950	4	78	0.87	8.10	35	600/(635)	520/(555)	475	315	190	140/(183)	62
29	50DSWQ15-40-5.5/JY	50	15	40	2950	5.5	81	0.88	11.00	30	600/(635)	520/(555)	410	310	185	132/(167)	68
30	50DSWQ25-25-5.5/JY	50	25	25	2950	5.5	81	0.88	11.00	30	600/(635)	520/(555)	410	310	185	132/(167)	68
31	65DSWQ30-30-5.5/JY	65	30	30	2950	5.5	81	0.88	11.00	30	605/(640)	525/(560)	410	315	180	132/(167)	65
32	80DSWQ40-22-5.5/JY	80	40	22	2950	5.5	81	0.88	11.00	30	625/(660)	545/(580)	440	315	185	140/(175)	74
33	80DSWQ65-15-5.5/JY	80	65	15	2950	5.5	81	0.88	11.00	30	625/(660)	545/(580)	440	315	185	140/(175)	74
34	80DSWQ85-10-5.5/JY	80	85	10	2950	5.5	81	0.88	11.00	30	625/(660)	545/(580)	440	315	185	140/(175)	74
35	100DSWQ65-15-5.5/JY	100	65	15	2950	5.5	81	0.88	11.00	35	625/(660)	545/(580)	475	315	195	140/(175)	74
36	100DSWQ85-10-5.5/JY	100	85	10	2950	5.5	81	0.88	11.00	35	625/(660)	545/(580)	475	315	195	140/(175)	74
37	150DSWQ100-7-5.5/JY	150	100	7	2950	5.5	81	0.88	11.00	45	720/(755)	560/(595)	540	330	195	145/(180)	83
38	50DSWQ20-40-7.5/JY	50	20	40	2950	7.5	82	0.88	15.00	25	690/(745)	590/(645)	445	345	185	140/(195)	95
39	50DSWQ30-32-7.5/JY	50	30	32	2950	7.5	82	0.88	15.00	25	690/(745)	590/(645)	445	345	185	140/(195)	95
40	65DSWQ25-35-7.5/JY	65	25	35	2950	7.5	82	0.88	15.00	25	690/(745)	590/(645)	470	355	185	140/(195)	73
41	80DSWQ45-25-7.5/JY	80	45	25	2950	7.5	82	0.88	15.00	30	710/(765)	610/(665)	510	365	205	146/(201)	100
42	80DSWQ65-20-7.5/JY	80	65	20	2950	7.5	82	0.88	15.00	30	710/(765)	610/(665)	510	365	205	146/(201)	100
43	100DSWQ80-15-7.5/JY	100	80	15	2950	7.5	82	0.88	15.00	35	710/(765)	610/(665)	525	365	205	151/(201)	103
44	100DSWQ45-25-7.5/JY	100	45	25	2950	7.5	82	0.88	15.00	35	710/(765)	610/(665)	525	365	205	151/(201)	103
45	150DSWQ100-12-7.5/JY	150	100	12	2950	7.5	82	0.88	15.00	45	800	630	575	365	200	180	108
46	150DSWQ135-10-7.5/JY	150	135	10	1475	7.5	82	0.85	16.00	45	855	685	575	520	300	235	143
47	65DSWQ20-56-11/JY	65	20	56	2950	11	83	0.89	22.00	25	850/(905)	780/(835)	500	365	195	185/(240)	148
48	80DSWQ40-45-11/JY	80	40	45	2950	11	83	0.89	22.00	30	850/(905)	780/(835)	500	365	195	185/(240)	153
49	100DSWQ80-25-11/JY	100	80	25	1475	11	83	0.85	23.00	35	910/(965)	710/(765)	700	540	325	210/(265)	212
50	150DSWQ130-15-11/JY	150	130	15	1475	11	83	0.85	23.00	45	950/(1005)	750/(805)	770	560	350	240/(295)	220

S/N	Model	Pump Outlet Diameter	Flow Rate Q	Head H	RPM n	Power P	Pump efficiency η	Motor power factor	Motor rated current	the maximum diameter of the particles d50	Dimension (mm)						Weight
		mm	m ³ /h	m	rpm	Kw	%	cosφ	A	mm	H	H1	B3	B22	L5	H2	kg
50	150DSWQ130-15-11/JY	150	130	15	1475	11	83	0.85	23.00	45	950/(1005)	750/(805)	770	560	350	240/(295)	220
51	150DSWQ200-10-11/JY	150	200	10	1475	11	83	0.85	23.00	45	950/(1005)	750/(805)	770	560	350	240/(295)	220
52	200DSWQ300-7-11/JY	200	300	7	1475	11	83	0.85	23.00	55	960/(1015)	760/(815)	870	580	355	240/(295)	230
53	100DSWQ80-30-15/JY	100	80	30	1475	15	84	0.85	30.00	35	950/(1005)	750/(805)	700	540	325	210/(265)	239
54	100DSWQ100-22-15/JY	100	100	22	1475	15	84	0.85	30.00	35	950/(1005)	750/(805)	700	540	325	210/(265)	239
55	150DSWQ130-20-15/JY	150	130	20	1475	15	84	0.85	30.00	45	990/(1045)	790/(845)	770	560	350	240/(295)	242
56	150DSWQ150-18-15/JY	150	150	18	1475	15	84	0.85	30.00	45	990/(1045)	790/(845)	770	560	350	240/(295)	242
57	150DSWQ200-15-15/JY	150	200	15	1475	15	84	0.85	30.00	45	990/(1045)	790/(845)	770	560	350	240/(295)	242
58	200DSWQ250-12-15/JY	200	250	12	1475	15	84	0.85	30.00	55	1000/(1055)	800/(855)	870	580	355	240/(295)	257
59	100DSWQ80-35-18.5/JY	100	80	35	1475	18.5	85	0.85	36.00	35	1060/(1055)	850/(905)	710	550	325	210/(265)	285
60	100DSWQ100-30-18.5/JY	100	100	30	1475	18.5	85	0.85	36.00	35	1060/(1055)	850/(905)	710	550	325	210/(265)	285
61	150DSWQ150-22-18.5/JY	150	150	22	1475	18.5	85	0.90	36.00	45	1080/(1135)	1030/(1085)	830	620	350	210/(265)	290
62	150DSWQ180-20-18.5/JY	150	180	20	1475	18.5	85	0.90	36.00	45	1080/(1135)	1030/(1085)	830	620	350	210/(265)	290
63	200DSWQ250-15-18.5/JY	200	250	15	1475	18.5	85	0.85	36.00	50	1120/(1175)	850/(905)	870	580	355	250/(305)	312
64	200DSWQ300-12-18.5/JY	200	300	12	1475	18.5	85	0.85	36.00	50	1120/(1175)	850/(905)	870	580	355	250/(305)	312
65	100DSWQ100-34-22/JY	100	100	34	1475	22	86	0.87	42.00	35	1180/(1205)	950/(956)	840	680	420	220/(275)	300
66	200DSWQ250-17-22/JY	200	250	17	1475	22	86	0.87	42.00	55	1150/(1205)	890/(945)	870	580	355	250/(305)	330
67	200DSWQ300-15-22/JY	200	300	15	1475	22	86	0.87	42.00	55	1150/(1205)	890/(945)	870	580	355	250/(305)	330
68	100DSWQ120-42-30/JY	100	120	42	1475	30	86	0.87	58.00	35	1250/(1315)	1050	870	710	450	220/(275)	432
69	150DSWQ180-30-30/JY	150	180	30	1475	30	86	0.87	58.00	45	1240	1000	860	650	380	240	455
70	150DSWQ250-22-30/JY	150	250	22	1475	30	86	0.87	58.00	45	1240	1000	860	650	380	240	455
71	200DSWQ360-16-30/JY	200	360	16	1475	30	86	0.87	58.00	55	1240	1000	910	620	380	285	475
72	250DSWQ600-9-30/JY	250	600	9	1475	30	86	0.87	58.00	70	1290	1050	1010	660	390	330	490
73	300DSWQ800-7-30/JY	300	800	7	1475	30	86	0.87	58.00	70	1440	1200	1475	720	410	305	475
74	350DSWQ1000-6-37/JY	350	1000	6	980	37	88	0.86	70.00	85	1500	1300	1540	720	510	380	785
75	150DSWQ180-34-37/JY	150	180	34	1475	37	89	0.87	70.00	45	1240	1000	935	725	380	270	528
76	150DSWQ250-27-37/JY	150	250	27	1475	37	89	0.87	70.00	45	1240	1000	935	725	380	270	528

S/N	Model	Pump Outlet Diameter	Flow Rate Q	Head H	RPM n	Power P	Pump efficiency η	Motor power factor	Motor rated current	the maximum diameter of the particles d50	Dimension (mm)						Weight
		mm	m ³ /h	m	rpm	Kw	%	cosφ	A	mm	H	H1	B3	B22	L5	H2	kg
78	200DSWQ400-18-37/JY	200	400	18	1475	37	89	0.87	70.00	55	1260	1020	910	620	380	285	528
79	250DSWQ600-13-37/JY	250	600	13	1475	37	89	0.87	70.00	70	1320	1080	1010	660	390	330	545
80	300DSWQ900-7-37/JY	300	900	7	1475	37	89	0.87	70.00	70	1440	1200	1475	720	410	380	567
81	350DSWQ1000-7-37/JY	350	1000	7	980	37	88	0.86	70.00	85	1500	1300	1540	720	510	380	785
82	150DSWQ180-37-45/JY	150	180	37	1475	45	89	0.87	85.00	45	1340	1100	1030	750	380	270	528
83	150DSWQ250-34-45/JY	150	250	34	1475	45	89	0.87	85.00	45	1340	1100	1030	750	380	270	528
84	200DSWQ400-25-45/JY	200	400	25	1475	45	89	0.87	85.00	55	1320	1100	910	620	380	285	575
85	250DSWQ600-16-45/JY	250	600	16	1475	45	89	0.87	85.00	70	1360	1100	1010	660	390	330	600
86	250DSWQ800-12-45/JY	250	800	12	1475	45	89	0.87	85.00	70	1360	1100	1010	660	390	330	600
87	300DSWQ900-9-45/JY	300	900	9	1475	45	89	0.87	85.00	70	1490	1250	1475	720	410	305	626
88	350DSWQ1000-10-45/JY	350	1000	10	1475	45	89	0.87	85.00	85	1500	1250	1530	1040	650	280	832
89	150DSWQ150-54-55	150	150	54	1475	55	90	0.87	103.00	45	1530	1300	1020	770	480	250	890
90	150DSWQ200-50-55	150	200	50	1475	55	90	0.87	103.00	45	1530	1300	1020	770	480	250	890
91	200DSWQ300-38-55	200	300	38	1475	55	90	0.87	103.00	55	1500	1150	1010	720	458	335	806
92	200DSWQ400-32-55	200	400	32	1475	55	90	0.87	103.00	55	1500	1150	1010	720	458	335	806
93	250DSWQ600-20-55	250	600	20	1475	55	90	0.87	103.00	70	1500	1150	1070	720	458	390	825
94	300DSWQ800-15-55	300	800	15	1475	55	89	0.87	103.00	70	1490	1250	1475	905	500	400	626
95	350DSWQ1100-10-55	350	1100	10	1475	55	89	0.87	103.00	85	1500	1200	1590	1130	680	429	832
96	400DSWQ1300-8-55	400	1300	8	980	55	90	0.87	103.00	85	1520	1200	1810	1200	670	380	1410
97	150DSWQ200-55-75	150	200	55	1475	75	90	0.87	140.00	45	1600	1350	1100	985	600	250	910
98	150DSWQ350-45-75	200	350	45	1475	75	90	0.87	140.00	55	1550	1250	1010	720	458	335	906
99	250DSWQ600-25-75	250	600	25	1475	75	90	0.87	140.00	65	1520	1180	1070	720	458	390	955
100	350DSWQ800-18-75	300	800	18	1475	75	90	0.87	140.00	80	1570	1170	1475	905	500	400	1010
101	350DSWQ1200-15-75	350	1200	15	980	75	90	0.82	155.00	85	1520	1200	1590	1150	700	380	1100
102	400DSWQ1400-12-75	400	1400	12	980	75	90	0.82	142.00	85	1580	1280	2055	1400	750	380	2010
103	200DSWQ350-50-90	200	350	50	1475	90	91	0.871	167.00	50	1700	1300	1400	780	520	300	1200
104	250DSWQ600-30-90	250	600	30	1475	90	91	0.871	167.00	65	1580	1200	1400	720	458	390	1008
105	300DSWQ900-22-90	300	900	22	1475	90	91	0.871	167.00	70	1570	1200	1475	905	500	400	1060
106	350DSWQ1100-18-90	350	1100	18	980	90	91	0.871	167.00	85	2365	2100	1590	1190	710	380	1410
107	400DSWQ1500-15-90	400	1500	15	980	90	90	0.810	170.00	95	2000	1700	2155	1500	900	380	1500
108	500DSWQ2000-10-90	500	2000	10	980	90	77	0.810	170.00	95	2100	1800	2210	1550	900	520	1600

DSWQ(JY)Sewage Submersible Pump Technical Parameters and Dimensions

S/N	Model	pump outlet diameter	flow rate Q	head H	power P	RPM n	voltage	the maximum diameter of the particles d50	dimension (mm)								weight
		mm	m ³ /h	m	kW	rpm	V	mm	L5	B2	H	H1	H2	L8	L9	L7	kg
1	40DSWQA10-10-0.75	40	10	10	0.75	2950	380/220	15	135	200	490	420	110	90	95	105	23
2	40DSWQA7-15-1.1	40	7	15	1.1	2950	380/220	15	135	200	490	420	110	85	90	95	24
3	40DSWQA15-8-1.1	40	15	8	1.1	2950	380/220	15	135	200	490	420	110	90	95	105	25
4	40DSWQA12-15-1.5/JY	40	12	15	1.5	2950	380/220	15	150	240	530	460	125	100	105	115	29
5	50DSWQA10-7-0.55	50	10	7	0.55	2950	380/220	15	135	200	490	420	110	90	95	105	23
6	50DSWQA10-10-0.75	50	10	10	0.75	2950	380/220	15	135	200	490	420	110	90	95	105	24
7	50DSWQA7-15-1.1	50	7	15	1.1	2950	380/220	15	135	200	490	420	110	85	90	95	25
8	50DSWQA15-8-1.1	50	15	8	1.1	2950	380/220	15	135	200	490	420	110	90	95	105	25
9	50DSWQA10-15-1.5/JY	50	10	15	1.5	2950	380/220	15	150	240	530	460	125	100	105	115	29
10	50DSWQA15-10-1.5/JY	50	15	10	1.5	2950	380/220	15	150	240	530	460	125	100	105	115	29
11	65DSWQA25-8-1.5/JY	65	25	8	1.5	2950	380/220	15	150	240	530	460	125	100	105	115	29
12	50DSWQA9-22-2.2/JY	50	9	22	2.2	2950	380/220	15	150	240	530	460	125	100	105	115	38
13	50DSWQA25-10-2.2/JY	50	25	10	2.2	2950	380/220	15	150	240	530	460	125	100	105	115	37
14	65DSWQA35-7-2.2/JY	65	35	7	2.2	2950	380/220	25	150	240	530	460	125	95	100	110	38
15	80DSWQA40-10-2.2/JY	80	40	10	2.2	2950	380/220	25	165	240	530	460	125	100	110	125	41
16	100DSWQA50-7-2.2/JY	100	50	7	2.2	2950	380	30	180	260	540	470	140	110	120	130	43
17	50DSWQA15-30-3/JY	50	15	30	3	2950	380	20	160	240	550	480	120	100	110	120	43
18	50DSWQA25-15-3/JY	50	25	15	3	2950	380	20	160	240	550	480	120	100	110	120	43
19	65DSWQA35-10-3/JY	65	35	10	3	2950	380	25	160	240	560	490	134	95	100	110	44
20	80DSWQA40-12-3/JY	80	40	12	3	2950	380	25	180	240	570	500	110	120	135	125	44
21	100DSWQA60-9-3/JY	100	60	9	3	2950	380	25	180	270	580	510	155	115	130	135	55
22	50DSWQA15-35-4/JY	50	15	35	4	2950	380	15	160	270	580	480	134	110	120	130	61
23	50DSWQA25-22-4/JY	50	25	22	4	2950	380	15	160	270	580	480	134	110	120	130	61
24	65DSWQA20-25-4/JY	65	20	25	4	2950	380	25	180	270	605	525	134	110	120	130	62
25	80DSWQA40-15-4/JY	80	40	15	4	2950	380	25	180	270	650	550	155	115	130	135	63
26	80DSWQA60-12-4/JY	80	60	12	4	2950	380	25	180	270	650	550	155	115	130	135	63
27	100DSWQA80-8-4/JY	100	80	8	4	2950	380	30	190	270	650	550	155	130	140	160	64
28	50DSWQA15-40-5.5/JY	50	15	40	5.5	2950	380	15	160	270	635	510	134	110	120	130	68
29	50DSWQA25-25-5.5/JY	50	25	25	5.5	2950	380	15	160	270	635	510	134	116	125	140	68
30	65DSWQA30-30-5.5/JY	65	30	30	5.5	2950	380	15	180	270	650	525	134	117	125	130	69

S/N	Model	pump outlet diameter	flow rate Q	head H	power P	RPM n	voltage	the maximum diameter of the particles d50	dimension (mm)								weight
		mm	m ³ /h	m	kW	rpm	V	mm	L5	B2	H	H1	H2	L8	L9	L7	kg
31	80DSWQA40-22-5.5/JY	80	40	22	5.5	2950	380	25	160	270	650	550	140	110	120	130	74
32	80DSWQA65-15-5.5/JY	80	65	15	5.5	2950	380	25	180	270	650	550	140	110	120	130	74
33	80DSWQA85-10-5.5/JY	80	85	10	5.5	2950	380	25	180	270	650	550	140	110	120	130	74
34	100DSWQA65-15-5.5/JY	100	65	15	5.5	2950	380	30	180	270	650	550	140	110	130	150	76
35	100DSWQA85-10-5.5/JY	100	85	10	5.5	2950	380	30	180	270	650	550	140	110	130	150	76
36	150DSWQA100-7-5.5/JY	150	100	7	5.5	1475	380	35	230	350	820	680	200	150	170	185	125
37	50DSWQA20-40-7.5/JY	50	20	40	7.5	1475	380	15	185	320	690	510	140	135	140	145	95
38	50DSWQA30-32-7.5/JY	50	30	32	7.5	1475	380	15	185	320	690	510	140	135	140	145	95
39	65DSWQA25-35-7.5/JY	65	25	35	7.5	1475	380	25	185	320	850	685	140	180	190	195	97
40	80DSWQA45-25-7.5/JY	80	45	25	7.5	1475	380	25	205	320	710	610	140	140	155	160	100
41	80DSWQA65-20-7.5/JY	80	65	20	7.5	2950	380	25	205	320	710	610	140	140	155	160	100
42	100DSWQA80-15-7.5/JY	100	80	15	7.5	2950	380	30	210	320	720	650	190	140	150	155	103
43	100DSWQA45-25-7.5/JY	100	45	25	7.5	2950	380	25	210	320	720	650	190	140	150	155	103
44	150DSWQA135-10-7.5/JY	150	135	10	7.5	2950	380	40	230	350	820	680	200	160	180	195	145
45	65DSWQA20-56-11/JY	65	20	56	11	2950	380	25	220	350	850	700	185	135	145	150	148
46	80DSWQA40-45-11/JY	80	40	45	11	2950	380	25	250	350	1050	800	156	170	190	200	153
47	100DSWQA45-40-11/JY	100	45	40	11	2950	380	30	325	350	1200	800	210	210	220	230	212
48	100DSWQA80-25-11/JY	100	80	25	11	1475	380	50	340	380	1200	800	210	210	220	230	280
49	150DSWQA130-15-11/JY	150	130	15	11	1475	380	60	360	380	1200	800	210	210	240	260	290
50	150DSWQA200-10-11/JY	150	200	10	11	1475	380	60	360	380	1200	800	210	210	240	260	290
51	200DSWQA300-7-11/JY	200	300	7	11	1475	380	70	420	380	1350	900	250	230	270	310	300
52	200DSWQA360-6-11/JY	200	360	6	11	1475	380	70	420	380	1350	900	250	230	270	310	300
53	100DSWQA80-30-15/JY	100	80	30	15	1475	380	50	340	380	1200	800	210	210	220	230	330
54	100DSWQA120-22-15/JY	100	120	22	15	1475	380	50	340	380	1200	800	210	210	220	230	330
55	150DSWQA150-18-15/JY	150	150	18	15	1475	380	60	360	380	1200	800	210	210	240	260	350
56	150DSWQA200-15-15/JY	150	200	15	15	1475	380	60	360	380	1200	800	210	210	240	260	350
57	200DSWQA400-7-15/JY	200	400	7	15	1475	380	70	420	380	1350	900	250	230	270	310	360
58	100DSWQA70-40-15/JY	100	70	40	15	2950	380	15	250	360	1250	800	150	160	170	180	220
59	100DSWQA100-30-18.5/JY	100	100	30	18.5	1475	380	50	385	380	1500	900	210	230	250	270	350
60	150DSWQA150-22-18.5/JY	150	150	22	18.5	1475	380	50	385	380	1500	900	210	230	250	270	370
61	200DSWQA250-15-18.5/JY	200	250	15	18.5	1475	380	80	450	380	1600	950	250	270	310	350	380
62	200DSWQA300-12-18.5/JY	200	300	12	18.5	1475	380	80	450	380	1600	950	250	270	310	350	380
63	250DSWQA500-8-18.5/JY	250	500	8	18.5	980	380	70	580	475	1800	950	270	315	370	435	530
64	80DSWQA50-65-22/JY	80	50	65	22	2950	380	10	280	300	1300	900	155	160	170	180	390
65	100DSWQA100-34-22/JY	100	100	34	22	1475	380	50	385	380	1500	900	210	230	250	270	370
66	150DSWQA130-30-22/JY	150	130	30	22	1475	380	50	385	380	1500	900	210	230	250	270	380
67	200DSWQA250-17-22/JY	200	250	17	22	1475	380	80	450	380	1600	950	250	270	310	350	390
68	200DSWQA300-15-22/JY	200	300	15	22	1475	380	80	450	380	1600	950	250	270	310	350	390
69	200DSWQA400-10-22/JY	200	400	10	22	1475	380	80	450	380	1600	950	250	270	310	350	390
70	250DSWQA700-6-22/JY	250	700	6	22	980	380	70	580	475	1800	1000	270	315	370	435	550
71	100DSWQA80-65-30/JY	100	80	65	30	2950	380	10	280	300	1300	900	155	160	170	180	430
72	150DSWQA100-40-30/JY	150	100	40	30	1475	380	55	425	475	1700	1100	225	260	280	300	550
73	150DSWQA150-36-30/JY	150	150	36	30	1475	380	55	425	475	1700	1100	225	260	280	300	550
74	150DSWQA250-22-30/JY	150	250	22	30	980	380	80	510	475	1800	1100					

S/N	Model	pump outlet diameter	flow rate Q	head H	power P	RPM n	voltage	the maximum diameter of the particles d50	dimension (mm)								weight
		mm	m ³ /h	m	kW	rpm	V	mm	L5	B2	H	H1	H2	L8	L9	L7	kg
77	250DSWQA800-8-30/JY	250	800	8	30	980	380	70	580	475	1800	1250	270	315	370	435	660
78	300DSWQA900-7-30/JY	300	900	7	30	980	380	70	580	475	1800	1300	270	315	370	435	700
79	350DSWQA1000-6-30/JY	350	1000	6	30	980	380	80	650	475	1850	1350	310	360	430	510	730
80	150DSWQA150-40-37/JY	150	150	40	37	1475	380	55	425	475	1700	1100	225	260	280	300	750
81	150DSWQA250-25-37/JY	150	250	25	37	980	380	80	510	475	1800	1100	290	300	325	350	800
82	200DSWQA300-22-37/JY	200	300	22	37	980	380	80	510	475	1800	1200	290	300	325	350	820
83	200DSWQA400-18-37/JY	200	400	18	37	980	380	80	560	475	1800	1200	270	300	330	360	820
84	250DSWQA600-13-37/JY	250	600	13	37	980	380	80	560	475	1800	1250	270	300	330	360	850
85	250DSWQA800-10-37/JY	250	800	10	37	980	380	70	580	475	1800	1250	270	315	370	435	850
86	300DSWQA900-8-37/JY	300	900	8	37	980	380	70	580	475	1800	1300	270	315	370	435	880
87	350DSWQA1200-6-37/JY	350	1200	6	37	980	380	80	650	475	1850	1350	310	360	430	510	920
88	150DSWQA150-48-45/JY	150	150	48	45	1475	380	35	460	475	1800	1100	220	260	285	320	950
89	150DSWQA240-35-45/JY	150	240	35	45	1475	380	35	460	475	1800	1100	220	260	285	320	950
90	200DSWQA400-25-45/JY	200	400	25	45	980	380	60	550	550	1950	1350	285	330	350	380	1000
91	250DSWQA600-16-45/JY	250	600	16	45	980	380	90	570	550	2000	1400	285	310	340	380	1050
92	250DSWQA800-12-45/JY	250	800	12	45	980	380	90	570	550	2000	1400	285	310	340	380	1050
93	300DSWQA900-12-45/JY	300	900	12	45	980	380	90	600	550	2000	1400	285	350	390	430	1100
94	350DSWQA1100-10-45/JY	350	1100	10	45	980	380	90	650	550	2050	1450	315	365	435	510	1200
95	150DSWQA150-60-55	150	150	60	55	1475	380	35	460	475	1800	1100	220	260	285	320	1350
96	150DSWQA200-50-55	150	200	50	55	1475	380	35	460	475	1800	1100	220	260	285	320	1350
97	200DSWQA300-40-55	200	300	40	55	1475	380	35	460	475	1800	1100	220	260	285	320	1400
98	200DSWQA400-34-55	200	400	34	55	1475	380	35	460	475	1800	1100	220	260	285	320	1400
99	250DSWQA600-20-55	250	600	20	55	980	380	90	570	550	2000	1400	285	310	340	380	1500
100	250DSWQA800-17-55	250	800	17	55	980	380	90	600	550	2000	1400	285	350	390	430	1500
101	300DSWQA900-15-55	300	900	15	55	980	380	90	600	550	2000	1400	285	350	390	430	1600
102	350DSWQA1200-10-55	350	1200	10	55	980	380	90	650	550	2050	1450	315	365	435	510	1700
103	400DSWQA1900-6-55	400	1900	6	55	740	380	90	700	750	2550	1800	510	440	535	600	1800
104	150DSWQA250-60-75	150	250	60	75	1475	380	35	600	550	2050	1300	230	345	385	430	1500
105	200DSWQA350-45-75	200	350	45	75	1475	380	35	600	550	2050	1300	230	345	385	430	1550
106	250DSWQA600-25-75	250	600	25	75	980	380	70	630	650	2300	1500	270	370	420	450	1650
107	300DSWQA800-22-75	300	800	22	75	980	380	70	700	650	2300	1500	270	420	480	530	1700
108	350DSWQA1200-15-75	350	1200	15	75	980	380	150	700	550	2450	1600	370	380	435	490	1750
109	400DSWQA2000-8-75	400	2000	8	75	740	380	90	700	750	2550	1800	510	440	535	600	2000
110	200DSWQA350-50-90	200	350	50	90	1475	380	35	600	550	2050	1300	230	345	385	430	1500
111	250DSWQA600-35-90	250	600	35	90	980	380	35	630	650	2300	1500	270	370	420	450	1750
112	300DSWQA900-24-90	300	900	24	90	980	380	70	700	650	2300	1500	270	420	480	530	1800
113	350DSWQA1200-18-90	350	1200	18	90	980	380	150	700	550	2450	1600	370	380	435	490	1900
114	400DSWQA1800-13-90	400	1800	13	90	980	380	150	750	550	2450	1700	370	380	435	490	2000
115	500DSWQA2700-7-90	500	2700	7	90	740	380	100	800	800	2680	1900	375	635	730	800	2700
116	200DSWQA350-60-110	200	350	60	110	1475	380	35	600	550	2100	1400	230	355	400	440	1600
117	250DSWQA600-40-110	250	600	40	110	980	380	35	630	650	2300	1700	270	370	420	450	2000
118	300DSWQA800-36-110	300	800	36	110	980	380	35	630	650	2450	1700	270	390	435	490	2100
119	300DSWQA1000-27-110	300	1000	27	110	980	380	70	700	650	2450	1700	270	420	480	530	2100
120	350DSWQA1200-20-110	350	1200	20	110	980	380	150	700	550	2450	1800	370	380	435	490	2200
121	400DSWQA1900-15-110	400	1900	15	110	980	380	150	700	550	2450	1800	370	380	435	490	2300
122	500DSWQA3000-8-110	500	3000	8	110	740	380	100	800	800	2680	2000	375	635	730	800	2850

S/N	Model	pump outlet diameter	flow rate Q	head H	power P	RPM n	voltage	the maximum diameter of the particles d50	dimension (mm)								weight
		mm	m ³ /h	m	kW	rpm	V	mm	L5	B2	H	H1	H2	L8	L9	L7	kg
123	250DSWQA500-55-132	250	500	55	132	1475	380	40	600	550	2200	1600	240	335	350	390	2000
124	250DSWQA600-50-132	250	600	50	132	1475	380	40	600	550	2200	1600	240	335	350	390	2000
125	300DSWQA900-36-132	300	900	36	132	980	380	70	700	650	2300	1500	270	420	480	530	2350
126	350DSWQA1100-30-132	350	1100	30	132	980	380	70	700	650	2300	1500	270	420	480	530	2450
127	350DSWQA1600-20-132	350	1600	20	132	980	380	150	700	550	2450	1800	370	380	435	490	2500
128	400DSWQA2200-15-132	400	2200	15	132	740	380	100	800	800	2900	2300	450	480	580	665	2650
129	500DSWQA3000-10-132	500	3000	10	132	740	380	100	800	800	2900	2300	450	480	580	665	2750
130	300DSWQA700-54-160	300	700	54	160	1475	380	40	650	550	2350	1600	240	335	360	390	2700
131	350DSWQA1100-35-160	350	1100	35	160	980	380	50	800	750	2800	2200	360	460	510	550	2900
132	400DSWQA1600-25-160	400	1600	25	160	980	380	50	800	750	2800	2200	360	460	510	550	3100
133	500DSWQA2600-16-160	500	2600	16	160	740	380	100	800	800	2900	2300	450	480	580	665	3100
134	500DSWQA3000-14-160	500	3000	14	160	740	380	100	800	800	2900	2300	450	480	580	665	3100
135	300DSWQA700-60-185	300	700	60	185	1475	380	40	650	550	2350	1600	240	335	360	390	2800
136	350DSWQA1100-40-185	350	1100	40	185	980	380	50	800	750	2800	2200	360	460	510	550	2900
137	400DSWQA1800-25-185	400	1800	25	185	740	380	80	1000	800	2850	2250	375	635	730	800	3500
138	500DSWQA2600-19-185	500	2600	19	185	740	380	100	800	800	2900	2300	450	480	580	665	3600
139	600DSWQA3500-12-185	600	3500	12	185	740	380	100	800	800	2900	2300	450	480	580	665	3800
140	300DSWQA700-63-200	300	700	63	200	1475	380	40	650	550	2350	1600	240	335	360	390	2900
141	350DSWQA1100-44-200	350	1100	44	200	980	380	50	800	750	2800	2200	360	460	510	550	3300
142	400DSWQA1700-30-200	400	1700	30	200	980	380	50	800	750	2800	2200	360	460	510	550	3400
143	500DSWQA2600-20-200	500	2600	20	200	740	380	100	800	800	2900	2300	450	480	580	665	3800
144	500DSWQA3000-17-200	500	3000	17	200	740	380	80	1000	800	2850	2250	375	635	730	800	3800
145	600DSWQA4000-12-200	600	4000	12	200	740	380	150	1350	900	3000	2400	500	650	750	820	4000
146	350DSWQA1400-42-220	350	1400	42	220	980	380	50	800	750	2800	2200	360	460	510	550	3600
147	400DSWQA2000-28-220	400	2000	28	220	740	380	80	1000	800	2850	2250	375	635	730	800	4200
148	500DSWQA2600-22-220	500	2600	22	220	740	380	80	1000	800	2850	2250	375	635	730		



Service Conditions

Product Description

1. DSF series all-stainless steel sewage submersible pumps are developed with international leading technology, it has been widely used in mining, construction, hospitals, municipal engineering, sewage treatment and other industries for more than ten years.
2. The electric pump over-current parts are all made of precision casting stainless steel, which can use 304, 316 and 316L, 2205 and other materials, expanded water supply and drainage application areas.
3. Electric pump is made of excellent stainless steel, with pure texture and beautiful appearance, reduced secondary pollution, fully meet the national green environmental protection requirements.
4. Electric pump is energy efficient, with reasonable structure, no blockage and anti-winding, which has safe and reliable operation and long service life characteristics.
5. According to equipped dual rail automated coupling device, pump is easy to install.
6. Mechanical seal with double seal material, use high-quality hard alloy such as tungsten carbide, and long-term operation in the oil chamber, which make the electric pump run safely for more than 10000 hours.

1. Medium temperature below 40°C, the solid content ratio is less than 2%, and the medium PH = 4 ~ 10.
2. Lowest operating level: See installation drawing ▼(with motor cooling system) or ▽(without motor cooling system).
3. The flow parts are precision stainless steel castings, which transport corresponding corrosive media.
4. The diameter of the maximum solid particle in the medium is less than the value in the parameter table d50, the length of fiber in the medium is less than the outlet diameter of the pump.

Product Pictures



Main Application

1. Suitable for construction engineering, Industrial and mining enterprises, municipal projects and other sewage treatment systems.
2. Sewage and sewage treatment in urban environmental protection system.
3. Exploration and mining auxiliary equipment.

Product Structure

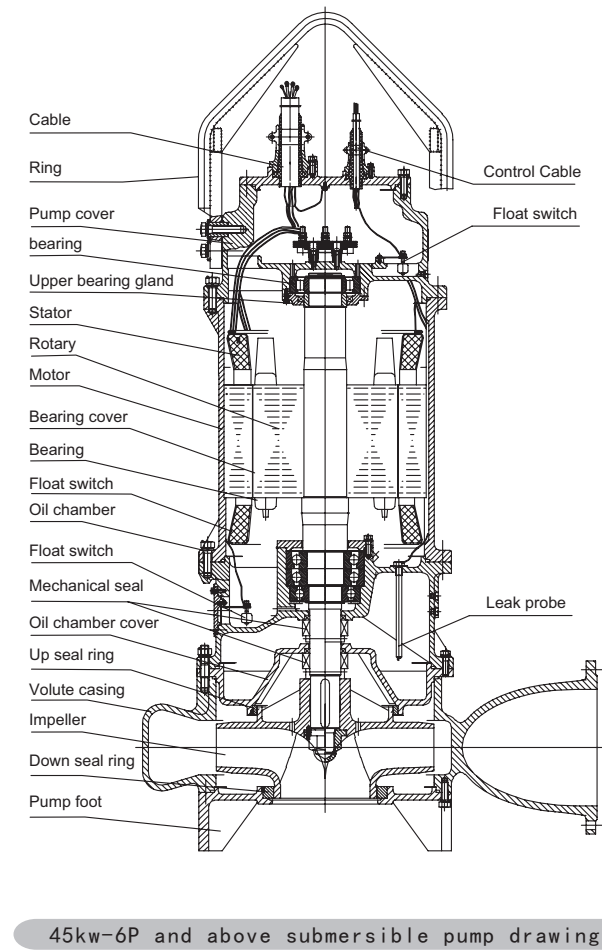
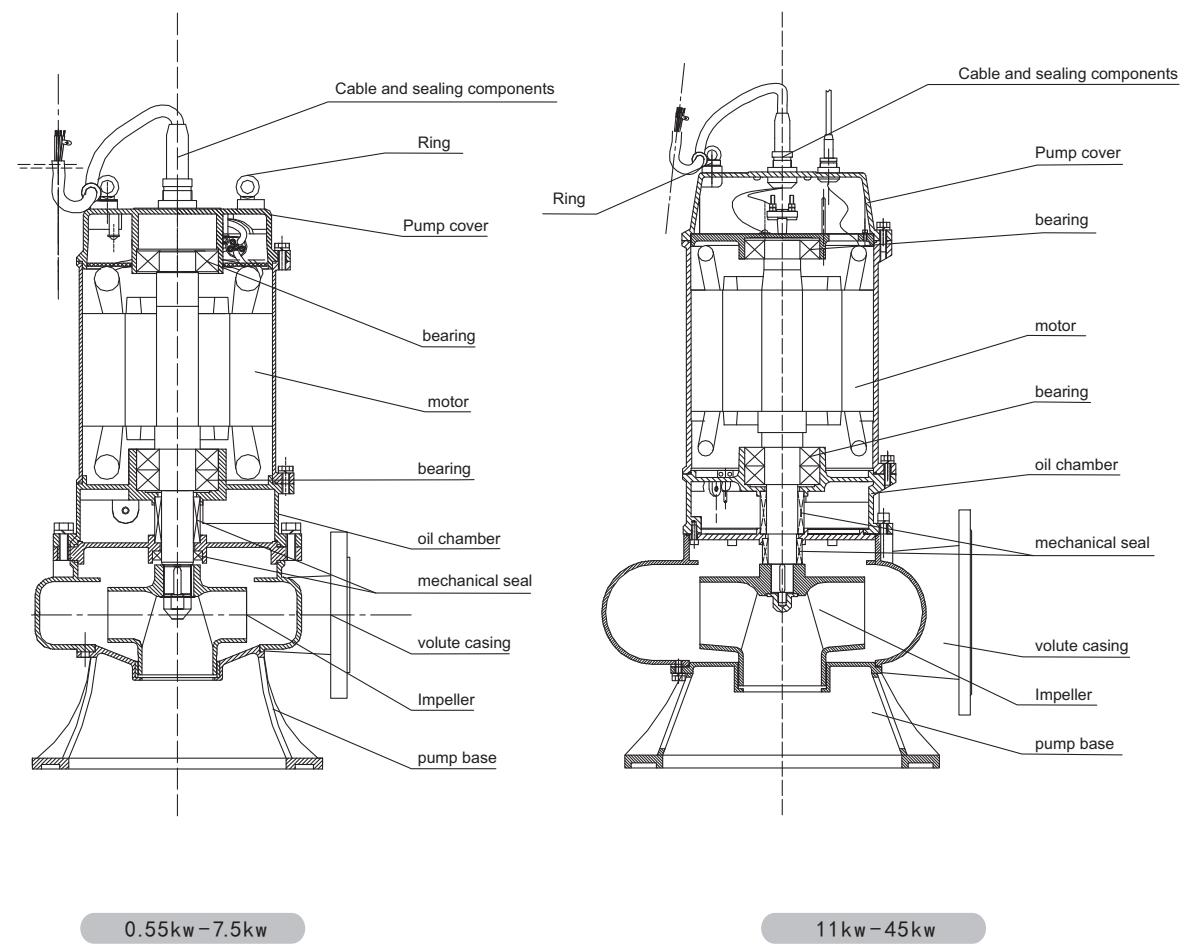

Production Description

1. Model Definition

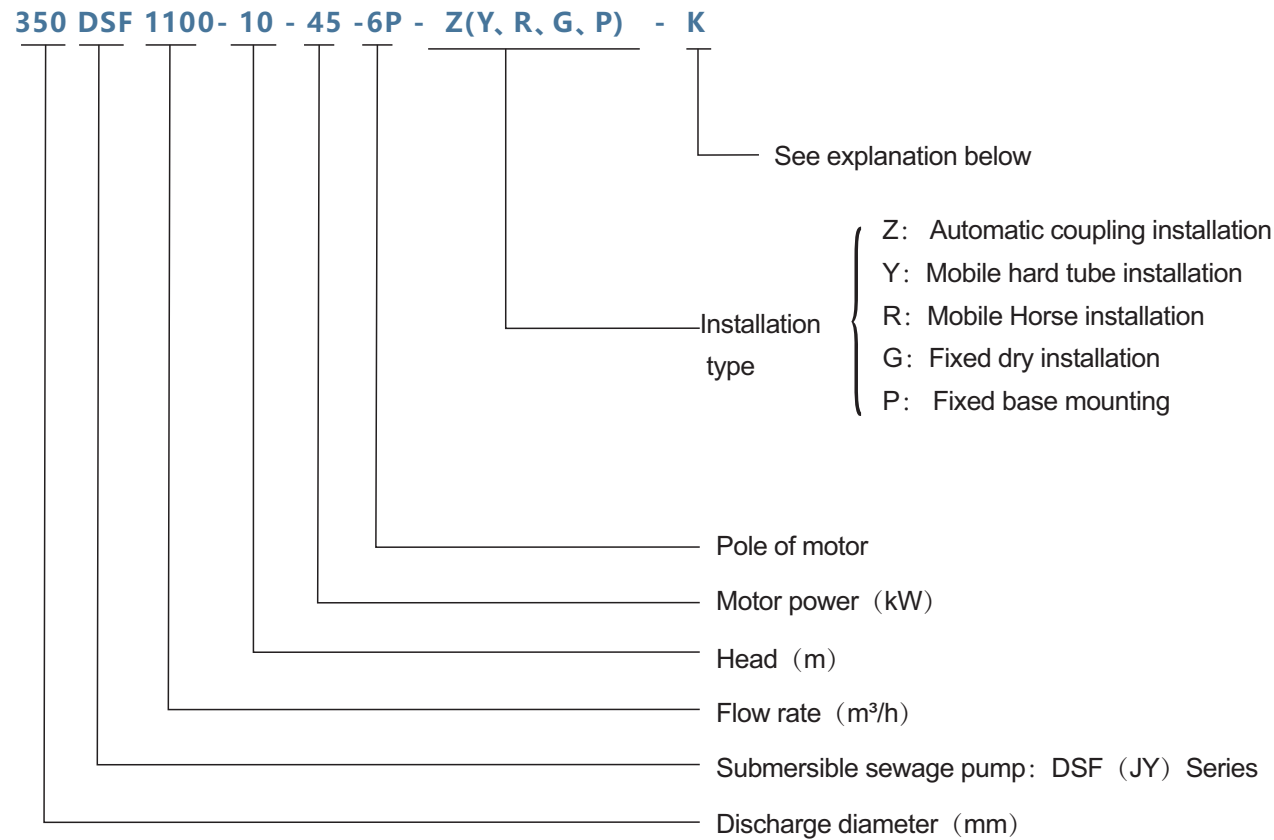

When the letter is not marked, it indicates the Δ connection method in the wiring cavity of the motor winding; when the standard K is indicated, the 6 wires of the motor winding are directly led out.

100DSF (JY) -4-2P-Z (Y、R、G、P) —K

4——Motor rated power (kW)

2P——Pole of motor.

JY——Pump with stirring function, 45kW and below DSWQ and DSF can equip with stirring device.

2.The rated voltage of the submersible pump motor is 380V, and the rated frequency is 50Hz.

- ① We can produce single-phase 220V submersible sewage pump with power of 0.55~2.2kW
- ② According to the customer needs electric pump unit frequency can be customized 60Hz
- ③ Electric pump units with three-phase voltages below 690V can be manufactured.

3.Connection and starting method of motor winding lead wire:

- ① 3kW and below motor windings are directly activated by Y-connection method;
- ② 4~11kW, 132kW and above motor winding by Δ wiring method, 4kW~11kW direct start; 132kW and above direct start, auto-coupled buck start or external electronic soft starter.
- ③ When the 6~10kW motor windings are directly led out, press Y- Δ to start or the internal electronic soft starter to started. When the Δ connection is used, the auto-reduction step-down or external electronic soft starter to started;
- ④ The 0.55~2.2kW220V single-phase electric pump has Capacitor and Dual-capacitor+Centrifugal switch modes for starting

4.The submersible sewage pump is equipped with various protection devices for protecting the motor. The electric control cabinet must be matched with these protection devices. The electric control cabinet should also be equipped with a float switch for liquid level control, so the electric control cabinet of the submersible sewage pump has special character.

- ① 3kW and below electric pump each phase winding has overheating and overcurrent protection components, equipped with automatic reset thermal switch automatic start and stop group, with air switch; can also be configured according to customer requirements
- ② The electric pump is equipped with a leaking water and oil-water normal- open probe, and the PTC of the temperature measuring component is embedded in each phase winding, and is provided according to customer requirements;
- ③ Electric pump lower bearing configuration temperature measuring component PT100, according to customer requirements

5.Whether the motor has a cooling system corresponding to different minimum liquid level values; the liquid level float switch is used when the electric control cabinet is placed in the automatic gear; the liquid level difference between the start and stop pumps is large, and two for the main pump or the large pump The float switch controls the start and stop liquid level; for a small pump or a super pump with an ultra-high liquid level, a float switch is used to control the start and stop liquid level;

6.When the electric control cabinet is far away, the terminal box can be set. When the threading pipe (user-supplied) is required, the inner diameter of the threading pipe is determined according to the outer diameter of the cable;

7.Viewed from the pump suction port, the impeller rotates counterclockwise;

8.The coupling flange of the coupling seat is in accordance with GB17241.6. The nominal pressure is PN6 with diameter ≤ 350 , PN10 with diameter ≥ 400 , and the outlet flange of stainless steel coupling seat is PN10. Cone and elbow are in accordance with customer requirements.

Material Configuration of Main Parts

Parts	Volute Casing- Impeller- Base	Motor Cover	Shaft	Mechanical Seal Components			
				Motor side friction pair	Pump side friction pair	Spring	Rubber components
Materials	Standard configuration 304	SiC / Graphite	TC / SiC SiC / SiC	Stainless	Nitrile rubber (NBR) Fluoro rubber(FKM) as option		
	Optional 316/ 316L/ 2205/ 2507						

Installation Method

1. Automatic coupling installation (Z) : The coupling device includes a guide rod, a guide rod frame, an outlet pipe seat and a coupling frame, and the pump and the pipe are connected, and the connection and disengagement of the pump and the pipe are made simple and easy without using the fastener; the pump of the same discharge port diameter can use the same Coupling device, see Figure 1
2. Fixed dry type installation (G) : The pump room and the sump are separate. The motor must have a cooling system. If the pump room is flooded, the pump runs normally. See Figure 2.
3. Fixed base type installation It is inconvenient to repair after the pump is running. If the pipeline is sufficiently rigid, the anchor bolts may not be installed. See Figure 3.
4. Mobile type installation (Y、R) : For emergency or repair, construction needs, the base can be connected to the hose or pipe to run, or the rigid drainage pipe can be used to suspend the pump, see Figure 4.

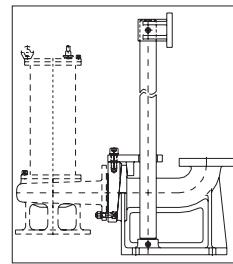

Figure 1

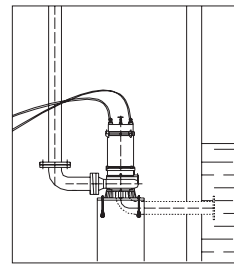

Figure 2

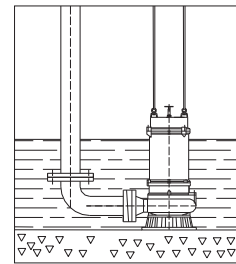

Figure 3

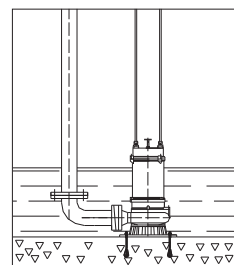
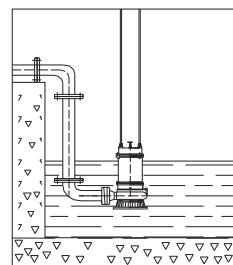
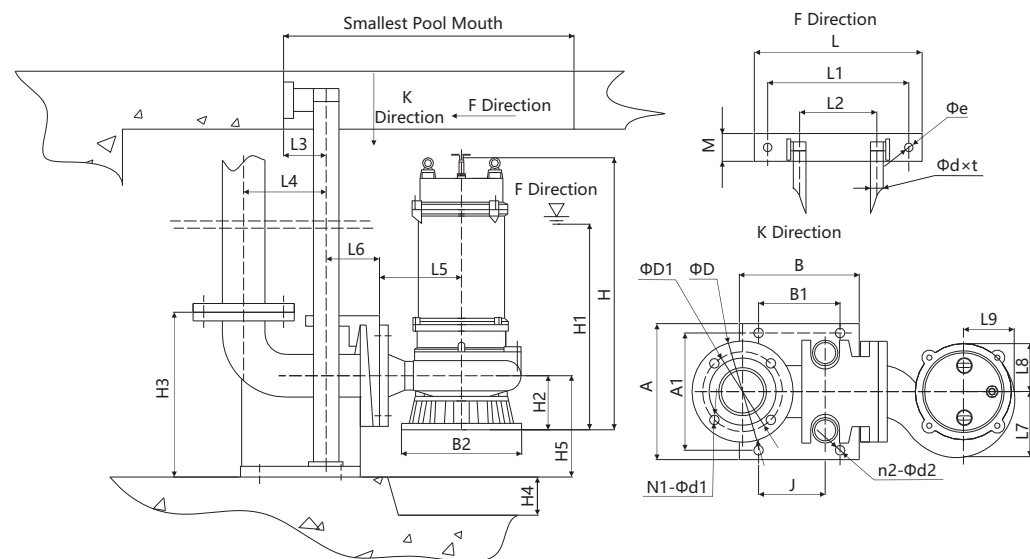

Figure 4

DSF Pump Dimension and Mobile Type Installation Drawing



DSF Coupling installation size data sheet(unit: mm)

S/N	Model	Flange connection dimension			Coupled base seat size						H3	H4	H5	L	L1	L2	M	Φe	L3	L4	L6	Φdxt
		D	D1	N1-Φd1	A	A1	B	B1	J	n2-Φd2												
2	50DSF	165	125	4-Φ19	180	140	270	190	214	4-Φ19	240	100	120	220	180	60	44	Φ12	50	152	52	Φ34 x 3
3	65DSF	180	145	4-Φ19	190	150	280	190	221	4-Φ19	240	100	120	220	180	60	44	Φ12	50	149	55	Φ34 x 3
4	80DSF	195	160	8-Φ19	230	170	300	210	235	4-Φ19	270	150	130	250	210	80	50	Φ15	57	165	63	Φ48 x 3
5	100DSF	215	180	8-Φ19	230	190	300	210	237	4-Φ25	300	150	150	250	210	80	50	Φ15	57	185	63	Φ48 x 3
6	150DSF	280	240	8-Φ23	300	250	460	330	367	4-Φ25	380	150	180	330	280	120	50	Φ19	62	305	76	Φ48 x 3
7	200DSF	335	295	8-Φ23	400	372	420	324	248	4-Φ25	508	200	277	410	370	192	50	Φ15	78	200	156	Φ48 x 3
8	250DSF	395	350	12-Φ23	420	360	580	450	471	4-Φ25	500	200	240	340	280	160	70	Φ23	115	359	95	Φ48 x 3
9	300DSF	445	400	12-Φ23	460	400	630	500	521	4-Φ25	560	200	260	380	320	200	70	Φ23	115	400	95	Φ60 x 3
10	350DSF	505	460	16-Φ23	650	419	645	400	320	4-Φ25	855	200	480	520	460	196	65	Φ16	145	424	285	Φ60 x 3
11	400DSF	565	515	16-Φ28	630	490	675	520	390	4-Φ25	965	200	560	520	350	196	65	Φ16	145	460	288	Φ60 x 3
13	500DSF	670	620	20-Φ28	650	550	700	600	580	4-Φ40	950	200	490	600	400	300	130	Φ22	130	600	250	Φ75 x 3

DSF Pump dimension and mobile type installation drawing

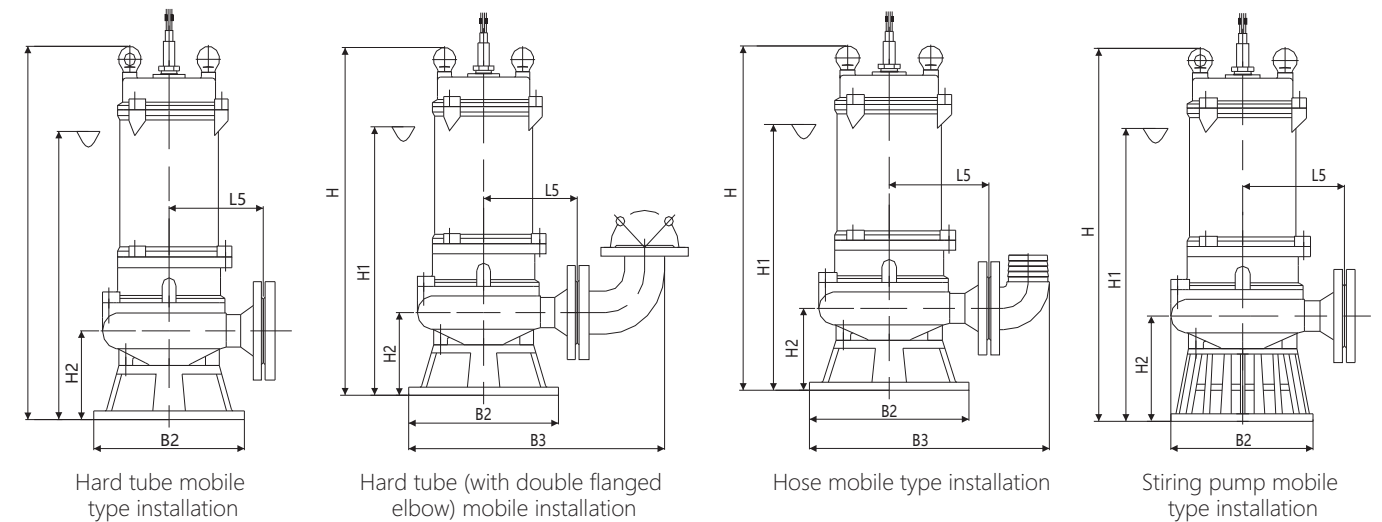

Spectrogram

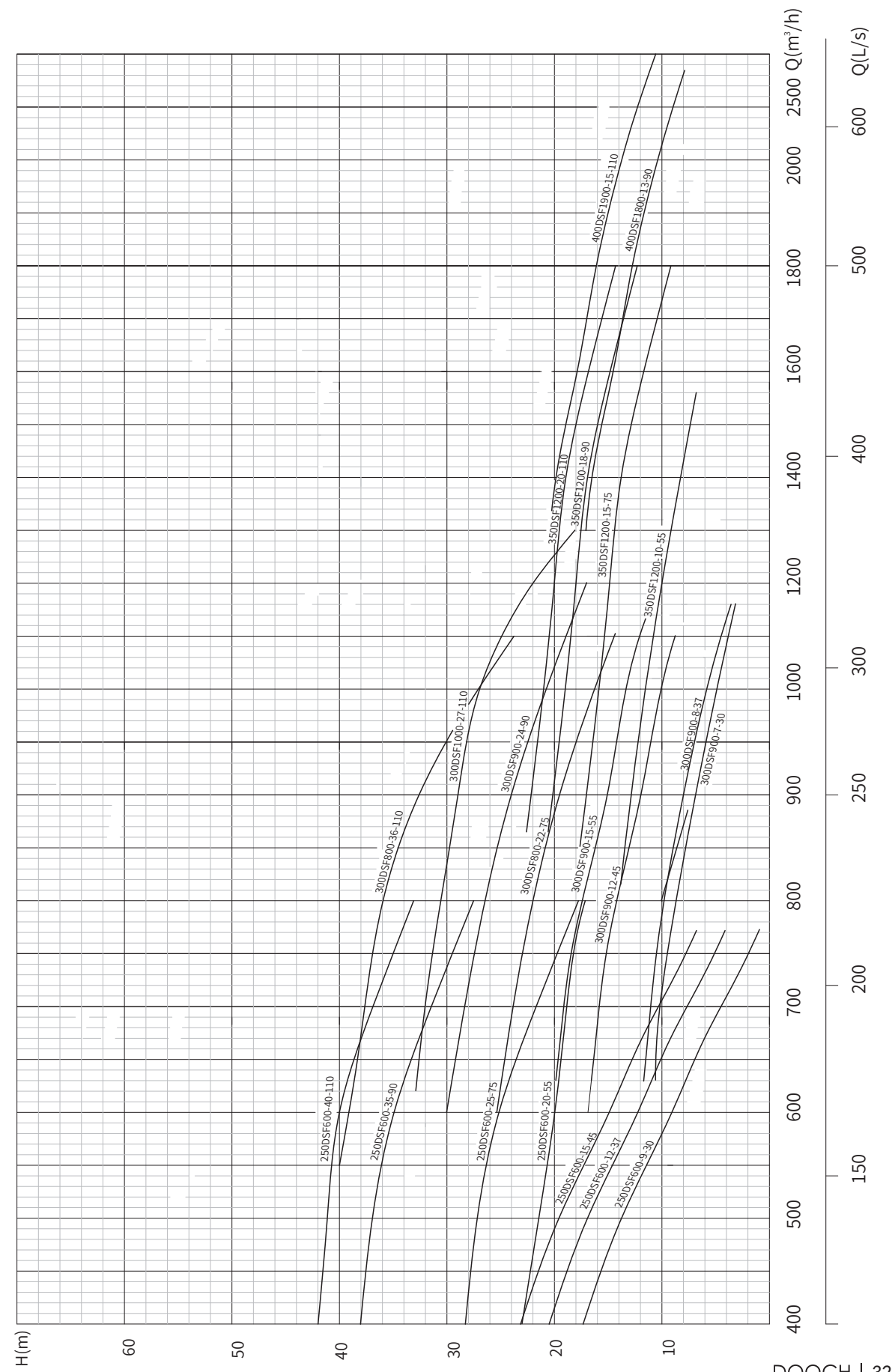
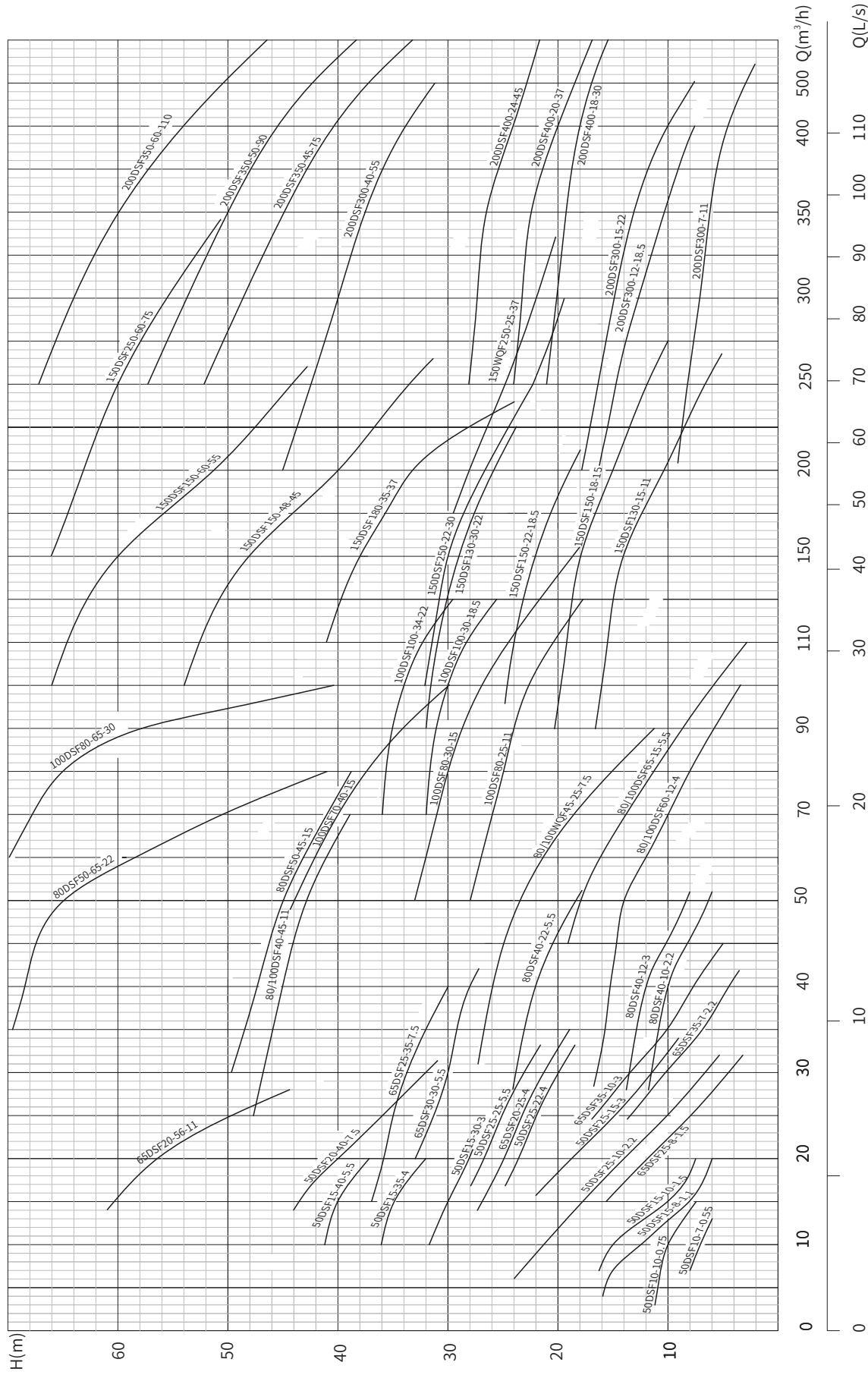

DSF (automatic mixing) sewage submersible pump technical parameters and dimensions

S/N	model	pump outlet diameter	flow rate Q	head H	power P	RPM n	voltage	the maximum diameter of the particles d50	dimension (mm)								weight kg
		mm	m ³ /h	m	kW	rpm	V		L5	B2	H	H1	H2	L8	L9	L7	
1	50DSF10-7-0.55	50	10	7	0.55	2950	380/220	15	135	200	490	420	110	90	95	105	23
2	50DSF10-10-0.75	50	10	10	0.75	2950	380/220	15	135	200	490	420	110	90	95	105	24
3	50DSF7-15-1.1	50	7	15	1.1	2950	380/220	15	135	200	490	420	110	85	90	95	25
4	50DSF15-8-1.1	50	15	8	1.1	2950	380/220	15	135	200	490	420	110	90	95	105	25
5	50DSF10-15-1.5	50	10	15	1.5	2950	380/220	15	150	240	530	460	125	100	105	115	29
6	50DSF15-10-1.5	50	15	10	1.5	2950	380/220	15	150	240	530	460	125	100	105	115	29
7	65DSF25-8-1.5	65	25	8	1.5	2950	380/220	15	150	240	530	460	125	100	105	115	29
8	50DSF9-22-2.2	50	9	22	2.2	2950	380	15	150	240	530	460	125	100	105	115	38
9	50DSF25-10-2.2	50	25	10	2.2	2950	380	15	150	240	530	460	125	100	105	115	37
10	65DSF35-7-2.2	65	35	7	2.2	2950	380	25	150	240	530	460	125	95	100	110	38
11	80DSF40-10-2.2	80	40	10	2.2	2950	380	25	165	240	530	460	125	100	110	125	41
12	50DSF15-30-3/JY	50	15	30	3	2950	380	20	160	240	550	480	120	100	110	120	43
13	50DSF25-15-3/JY	50	25	15	3	2950	380	20	160	240	550	480	120	100	110	120	43
14	65DSF35-10-3/JY	65	35	10	3	2950	380	25	160	240	560	490	134	95	100	110	44
15	80DSF40-12-3/JY	80	40	12	3	2950	380	25	180	240	570	500	110	120	135	125	44
16	50DSF15-35-4/JY	50	15	35	4	2950	380	15	160	270	580	480	134	110	120	130	61
17	50DSF25-22-4/JY	50	25	22	4	2950	380	15	160	270	580	480	134	110	120	130	61
18	65DSF20-25-4/JY	65	20	25	4	2950	380	25	180	270	605	525	134	110	120	130	62
19	80DSF40-15-4/JY	80	40	15	4	2950	380	25	180	270	650	550	155	115	130	135	63
20	80DSF60-12-4/JY	80	60	12	4	2950	380	25	180	270	650	550	155	115	130	135	63
21	100DSF80-8-4/JY	100	80	8	4	2950	380	30	190	270	650	550	155	130	140	160	64
22	50DSF15-40-5.5/JY	50	15	40	5.5	2950	380	15	160	270	635	510	134	110	120	130	68
23	50DSF25-25-5.5/JY	50	25	25	5.5	2950	380	15	160	270	635	510	134	116	125	140	68

S/N	model	pump outlet diameter	flow rate Q	head H	power P	RPM n	voltage	the maximum diameter of the particles d50	dimension (mm)								weight kg
		mm	m ³ /h	m	kW	rpm	V		L5	B2	H	H1	H2	L8	L9	L7	
24	65DSF30-30-5.5/JY	65	30	30	5.5	2950	380	15	180	270	650	525	134	117	125	130	69
25	80DSF40-20-5.5/JY	80	40	20	5.5	2950	380	25	160	270	650	550	140	110	120	130	74
26	80DSF65-15-5.5/JY	80	65	15	5.5	2950	380	25	180	270	650	550	140	110	120	130	74
27	80DSF85-10-5.5/JY	80	85	10	5.5	2950	380	25	180	270	650	550	140	110	120	130	74
28	100DSF65-15-5.5/JY	100	65	15	5.5	2950	380	30	180	270	650	550	140	110	130	150	76
29	100DSF85-10-5.5/JY	100	85	10	5.5	2950	380	30	180	270	650	550	140	110	130	150	76
30	50DSF20-40-7.5/JY	50	20	40	7.5	1475	380	15	185	320	690	510	140	135	140	145	95
31	50DSF30-32-7.5/JY	50	30	32	7.5	1475	380	15	185	320	690	510	140	135	140	145	95
32	65DSF25-35-7.5/JY	65	25	35	7.5	1475	380	25	185	320	850	685	140	180	190	195	97
33	80DSF45-25-7.5/JY	80	45	25	7.5	1475	380	25	205	320	710	610	140	140	155	160	100
34	80DSF65-20-7.5/JY	80	65	20	7.5	2950	380	25	205	320	710	610	140	140	155	160	100
35	100DSF80-15-7.5/JY	100	80	15	7.5	2950	380	30	210	320	720	650	190	140	150	155	103
36	100DSF45-25-7.5/JY	100	45	25	7.5	2950	380	25	210	320	720	650	190	140	150	155	103
37	65DSF20-56-11/JY	65	20	56	11	2950	380	25	220	350	850	700	185	135	145	150	148
38	80DSF40-45-11/JY	80	40	45	11	2950	380	25	250	350	1050	800	156	170	190	200	153
39	100DSF45-40-11/JY	100	45	40	11	2950	380	30	325	350	1200	800	210	210	220	230	212
40	100DSF80-25-11/JY	100	80	25	11	1475	380	50	340	380	1200	800	210	210	220	230	280
41	150DSF130-15-11/JY	150	130	15	11	1475	380	60	360	380	1200	800	210	210	240	260	290
42	150DSF200-10-11/JY	150	200	10	11	1475	380	60	360	380	1200	800	210	210	240	260	290
43	200DSF300-7-11/JY	200	300	7	11	1475	380	70	420	380	1350	900	250	230	270	310	300
44	80DSF50-45-15/JY	80	50	45	15	2950	380	15	250	440	1050	700	220	180	185	190	200
45	100DSF80-30-15/JY	100	80	30	15	1475	380	50	340	380	1200	800	210	210	220	230	330
46	100DSF120-22-15/JY	100	120	22	15	1475	380	50	340	380	1200	800	210	210	220	230	330
47	150DSF150-18-15/JY	150	150	18	15	1475	380	60	360	380	1200	800	210	210	240	260	350

S/N	model	pump outlet diameter	flow rate Q	head H	power P	RPM n	voltage	the maximum diameter of the particles d50	dimension (mm)								weight
		mm	m ³ /h	m	kW	rpm	V	mm	L5	B2	H	H1	H2	L8	L9	L7	kg
48	150DSF200-15-15/JY	150	200	15	15	1475	380	60	360	380	1200	800	210	210	240	260	350
49	100DSF70-40-15/JY	100	70	40	15	2950	380	15	250	360	1250	800	150	160	170	180	220
50	100DSF100-30-18.5/JY	100	100	30	18.5	1475	380	50	385	380	1500	900	210	230	250	270	350
51	150DSF150-22-18.5/JY	150	150	22	18.5	1475	380	50	385	380	1500	900	210	230	250	270	370
52	200DSF250-15-18.5/JY	200	250	15	18.5	1475	380	80	450	380	1600	950	250	270	310	350	380
53	200DSF300-12-18.5/JY	200	300	12	18.5	1475	380	80	450	380	1600	950	250	270	310	350	380
54	80DSF50-65-22/JY	80	50	65	22	2950	380	10	280	300	1300	900	155	160	170	180	390
55	100DSF100-34-22/JY	100	100	34	22	1475	380	50	385	380	1500	900	210	230	250	270	370
56	150DSF130-30-22/JY	150	130	30	22	1475	380	50	385	380	1500	900	210	230	250	270	380
57	200DSF250-17-22/JY	200	250	17	22	1475	380	80	450	380	1600	950	250	270	310	350	390
58	200DSF300-15-22/JY	200	300	15	22	1475	380	80	450	380	1600	950	250	270	310	350	390
59	200DSF400-10-22/JY	200	400	10	22	1475	380	80	450	380	1600	950	250	270	310	350	390
60	100DSF80-65-30/JY	100	80	65	30	2950	380	10	280	300	1300	900	155	160	170	180	430
61	150DSF150-30-30/JY	150	150	30	30	1475	380	45	380	500	1240	1000	240	240	260	280	455
62	150DSF250-22-30/JY	150	250	22	30	1475	380	45	380	500	1240	1000	240	240	260	280	455
63	200DSF400-18-30/JY	200	400	18	30	1475	380	55	380	500	1240	1000	285	260	290	310	475
64	250DSF600-9-30/JY	250	600	9	30	1475	380	65	390	500	1290	1050	285	260	290	310	475
65	300DSF900-7-30/JY	300	900	7	30	980	380	70	580	475	1800	1300	270	315	370	435	700
66	150DSF180-35-37/JY	150	180	35	37	1475	380	45	380	500	1240	1000	270	260	280	300	485
67	150DSF250-25-37/JY	150	250	25	37	980	380	80	510	475	1800	1100	290	300	325	350	800
68	200DSF400-20-37/JY	200	400	20	37	1475	380	50	380	500	1260	1000	285	270	290	310	528
69	200DSF500-17-37/JY	200	500	17	37	1475	380	50	380	500	1260	1000	285	270	290	310	528
70	250DSF600-12-37/JY	250	600	12	37	1475	380	65	390	530	1320	1060	330	270	300	330	545

S/N	model	pump outlet diameter	flow rate Q	head H	power P	RPM n	voltage	the maximum diameter of the particles d50	dimension (mm)								weight
		mm	m ³ /h	m	kW	rpm	V	mm	L5	B2	H	H1	H2	L8	L9	L7	kg
71	300DSF900-8-37/JY	300	900	8	37	980	380	70	580	475	1800	1300	270	315	370	435	880
72	150DSF150-48-45/JY	150	150	48	45	1475	380	35	460	475	1800	1100	220	260	285	320	950
73	150DSF240-35-45/JY	150	240	35	45	1475	380	35	460	475	1800	1100	220	260	285	320	950
74	200DSF400-24-45/JY	200	400	24	45	1475	380	60	380	500	1320	1100	285	270	290	310	575
75	200DSF500-22-45/JY	200	500	22	45	1475	380	60	380	500	1320	1100	285	270	290	310	575
76	250DSF600-15-45/JY	250	600	15	45	1475	380	75	390	530	1360	1140	330	270	300	330	600
77	300DSF900-12-45/JY	300	900	12	45	980	380	90	600	550	2000	1400	285	350	390	430	1100
78	150DSF150-60-55	150	150	60	55	1475	380	35	460	475	1800	1100	220	260	285	320	1350
79	150DSF200-50-55	150	200	50	55	1475	380	35	460	475	1800	1100	220	260	285	320	1350
80	200DSF300-40-55	200	300	40	55	1475	380	35	460	475	1800	1100	220	260	285	320	1400
81	200DSF400-34-55	200	400	34	55	1475	380	35	460	475	1800	1100	220	260	285	320	1400
82	250DSF600-20-55	250	600	20	55	980	380	90	570	550	2000	1400	285	310	340	380	1500
83	250DSF800-17-55	250	800	17	55	980	380	90	600	550	2000	1400	285	350	390	430	1500
84	300DSF900-15-55	300	900	15	55	980	380	90	600	550	2000	1400	285	350	390	430	1600
85	350DSF1200-10-55	350	1200	10	55	980	380	90	650	550	2050	1450	315	365	435	510	1700
86	150DSF250-60-75	150	250	60	75	1475	380	35	600	550	2050	1300	230	345	385	430	1500
87	200DSF350-45-75	200	350	45	75	1475	380	35	600	550	2050	1300	230	345	385	430	1550
88	250DSF600-25-75	250	600	25	75	980	380	70	630	650	2300	1500	270	370	420	450	1650
89	300DSF800-22-75	300	800	22	75	980	380	70	700	650	2300	1500	270	420	480	530	1700
90	350DSF1200-15-75	350	1200	15	75	980	380	150	700	550	2450	1600	370	380	435	490	1750
91	200DSF350-50-90	200	350	50	90	1475	380	35	600	550	2050	1300	230	345	385	430	1500
92	250DSF600-35-90	250	600	35	90	980	380	35	630	650	2300	1500	270	370	420	450	1750
93	300DSF900-24-90	300	900	24	90	980	380	70	700	650	2300	1500	270	420	480	530	1800
94	350DSF1200-18-90	350	1200	18	90	980	380	150	700	550	2450	1600	370	380	435	490	1900
95	400DSF1800-13-90	400	1800	13	90	980	380	150	750	550	2450	1700	370	380	435	490	2000
96	200DSF350-60-110	200	350	60	110	1475	380	35	600	550	2100	1400	230	355	400	440	1600
97	250DSF600-40-110	250	600	40	110	980	380	35	630	650	2300	1700	270	370	420	450	2000
98	300DSF800-36-110	300	800	36	110	980	380	35	630	650	2450	1700	270	390	435	490	2100
99	300DSF1000-27-110	300	1000	27	110	980	380	70	700	650	2450	1700	270	420	480	530	2100
100	350DSF1200-20-110	350	1200	20	110	980	380	150	700	550	2450	1800	370	380	435	490	2200
101	400DSF1900-15-110	400	1900	15	110	980	380	150	700	550	2450	1800	370	380	435	490	2300



Product Description

1. DS-F series small stainless steel submersible sewage pump is made of high quality stainless steel plate and processed by special process. It is widely used in household, building, industrial and mining enterprises and other sewage discharge fields.
2. The electric pump is made of 304# or 316# stainless steel. The texture is pure and beautiful, which reduces secondary pollution and fully meets the requirements of national green environmental protection.
3. The electric pump is energy-efficient, reasonable in structure, non-blocking, anti-winding, small in size, light in weight, safe and reliable in operation, and long in service life.

Model Definition

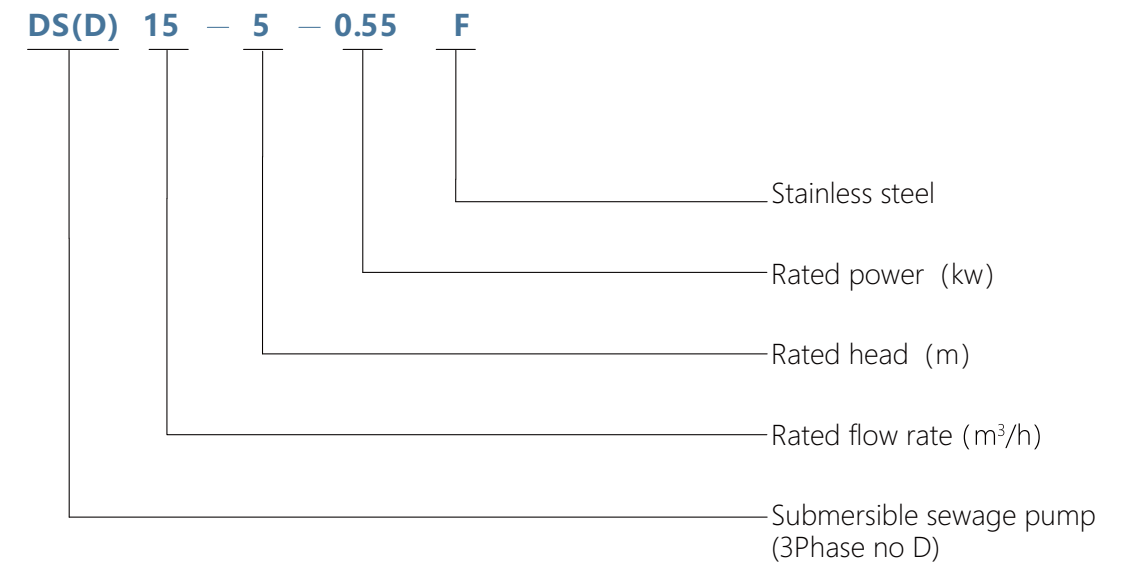

Product Pictures

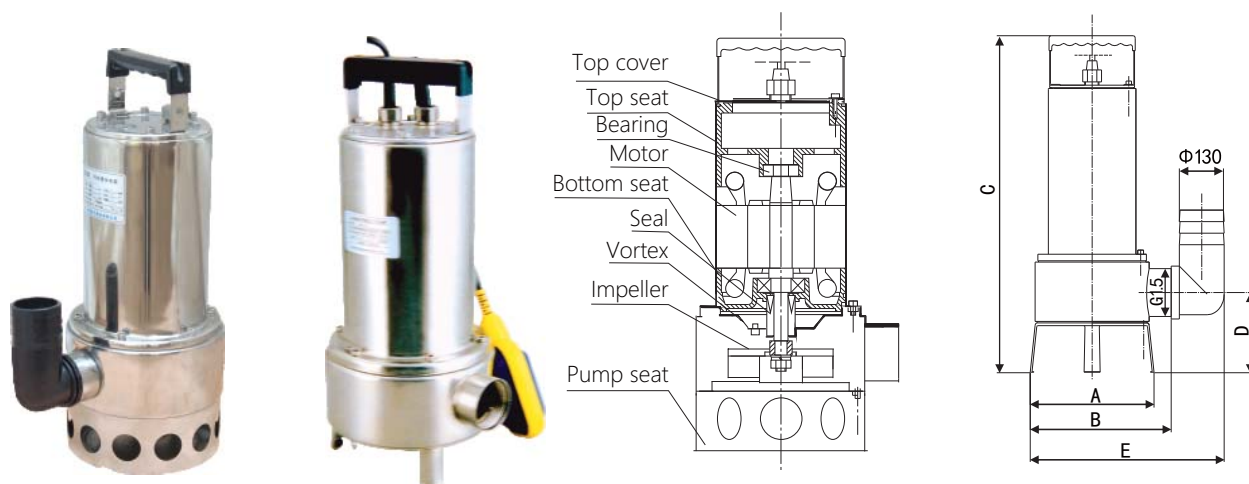

Working Conditions

- The depth for pump under water is $\leq 5\text{m}$
- Medium temperature $\leq 40^\circ\text{C}$
- Medium weight $< 1.2\text{kg}/\text{dm}^3$, Particle content weight ratio of pumping medium $> 60\%$, PH: 4-10
- When the electric pump is working, the liquid surface level of the motor part shall not exceed 1/2 of the motor. The single-phase electric pump may be equipped with float switch.

Performance Curve

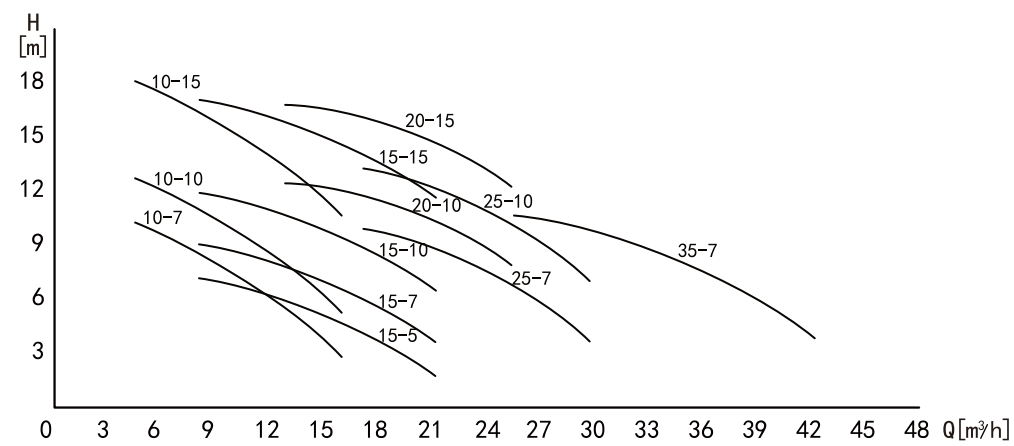

Technical Parameters

Model	Rated flow	Rated head	Rated power	RPM/min	Rated voltage	Rated current	Rated frequency	Piping inner diameter	Weight
	m³/h	m	kW	r/min	v	A	Hz	mm	kg
DS10-7-0.55F	10	7	0.55	3000	220/380	5/1.4	50/60	40	14
DS15-5-0.55F	15	5	0.55	3000	220/380	5/1.4	50/60	40	14
DS10-10-0.75F	10	10	0.75	3000	220/380	5.4/2	50/60	40	15
DS15-7-0.75F	15	7	0.75	3000	220/380	5.4/2	50/60	40	15
DS10-15-1.1F	10	15	1.1	3000	220/380	6.5/2.6	50/60	40	16
DS15-10-1.1F	15	10	1.1	3000	220/380	6.5/2.6	50/60	40	16
DS20-10-1.5F	20	10	1.5	3000	380	3.6	50/60	50	19
DS25-7-1.5F	25	7	1.5	3000	380	3.6	50/60	50	19
DS25-10-2.2F	25	10	2.2	3000	380	4.8	50/60	80	21
DS35-7-2.2F	35	7	2.2	3000	380	4.8	50/60	80	21



Product Description

DSWQ-QX type anti-winding cutting pump tackle the most difficult sewage challenge, solve the problem of transporting and discharging complex media in sewage. This series of cutting pump impeller is semi-open type, The two blade inlet spaces are twisted into spirals, the inlet blade has an axial part, and the fiber is attracted to the flow channel by the blade wheel to avoid winding, the guide pins of the cutting disk divert impurity fibers into the impeller flow path, and some long-fibers slide into the cutting disk guide grooves, which are cut off by the high speed rotating impeller blade and the cutting disk convex surface and discharged with the direction of fluid flow. Therefore, the impurities in the flow parts are removed and medium are conveyed after cutting or grinding, guaranteed DSWQ-QX performance without overload. DSWQ-QX series with maximum head(50m) and maximum flow(60l/s), motor power 0.75~15kW.

The products have been designed carefully and manufactured with perfect quality control, reach the domestic leading level and replace the corresponding imported pump type, achieve reliable, energy-efficient operational goals. Our company has passed ISO9001 quality certification and 3C certification, product quality can be fully guaranteed.

Products Character

- 1.Impeller with double helix blade, without front cover, cooperate with the cutting disc to ensure that the performance parameters are not reduced;
- 2.Cutting disc with split guide pin, prevent inlet winding;
- 3.The blade cooperate with the cutting disc guide groove, produce cutting and clearing function.

Scope of application

Mainly used in municipal projects, building construction, hospital, hotel, restaurant, farming and sewage industry etc. It is used for cutting and conveying solid particles and long fiber cloth, tough fiber such as plastic weaving, rope, motor cable rubber skin, plastic bottle, labor protection glove and other sewage.

Conditions of using

- 1.The medium temperature does not exceed 40°C, the solid phase volume ratio in medium is less than 2%;
- 2.The medium cannot be highly corrosive, PH=4~10, corrosiveness should be matched with material of flow parts.
- 3.The maximum particle size and fiber diameter of the solids in the medium are less than the value of the performance parameter table d50;
- 4.Minimum operating level: see the installation dimension drawing ▽

Technical Explanations

1.Product model and Definition

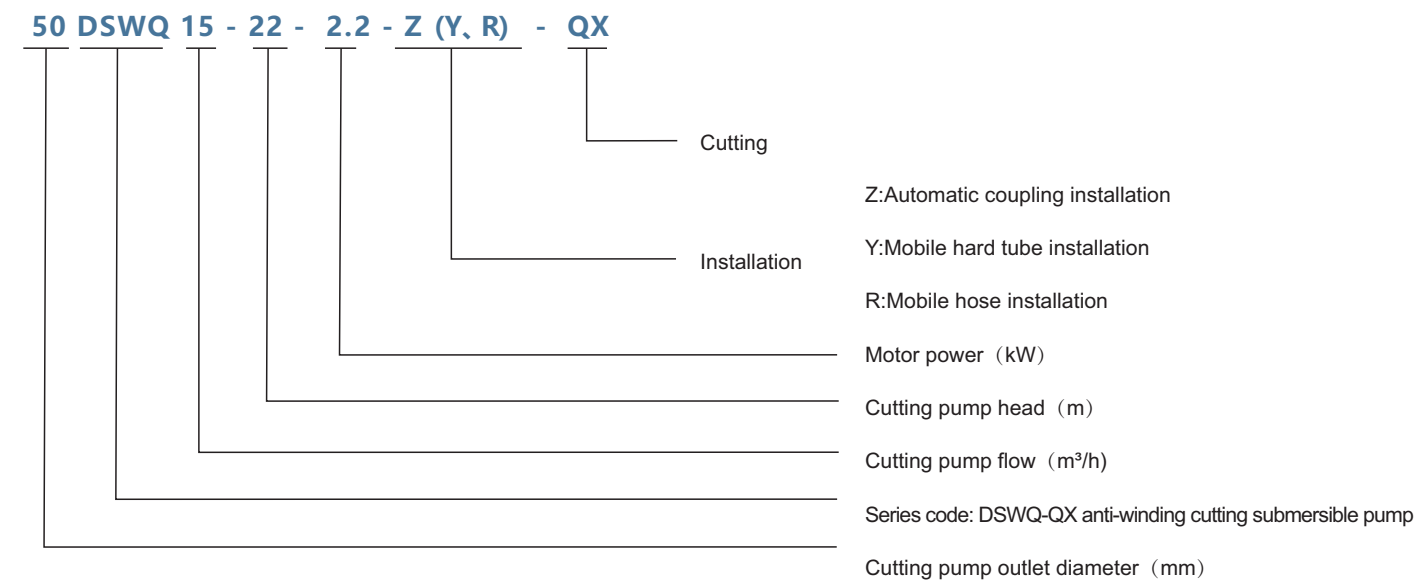

2. Rated motor voltage 380V (0.75~1.5kW motor can have 220V voltage), rated frequency 50Hz;
3. Connection and starting method of motor winding lead wire:
 - ①3kW and below motor winding use Y-wire method, start directly;
 - ②4~11kW motor winding use A-wire method, start directly, 15kW is not recommended to start directly;
 - ③0.75~2.2kW 220V Single phase electric pump is capacitor operation, double capacitance + centrifugal switch start;
4. Various protection devices for protecting the motor can be provided in the cutting pump according to requirements;
5. The impeller rotates counterclockwise from the suction inlet of the pump;
6. Pump body outlet flange standard GB17241.6, nominal pressure is PN 6, cone and elbow meet customer requirements.

Product Structure

Figure 1 (0.75~7.5k cutting pump structure) Figure 2 (11kw and above cutting pump structure)

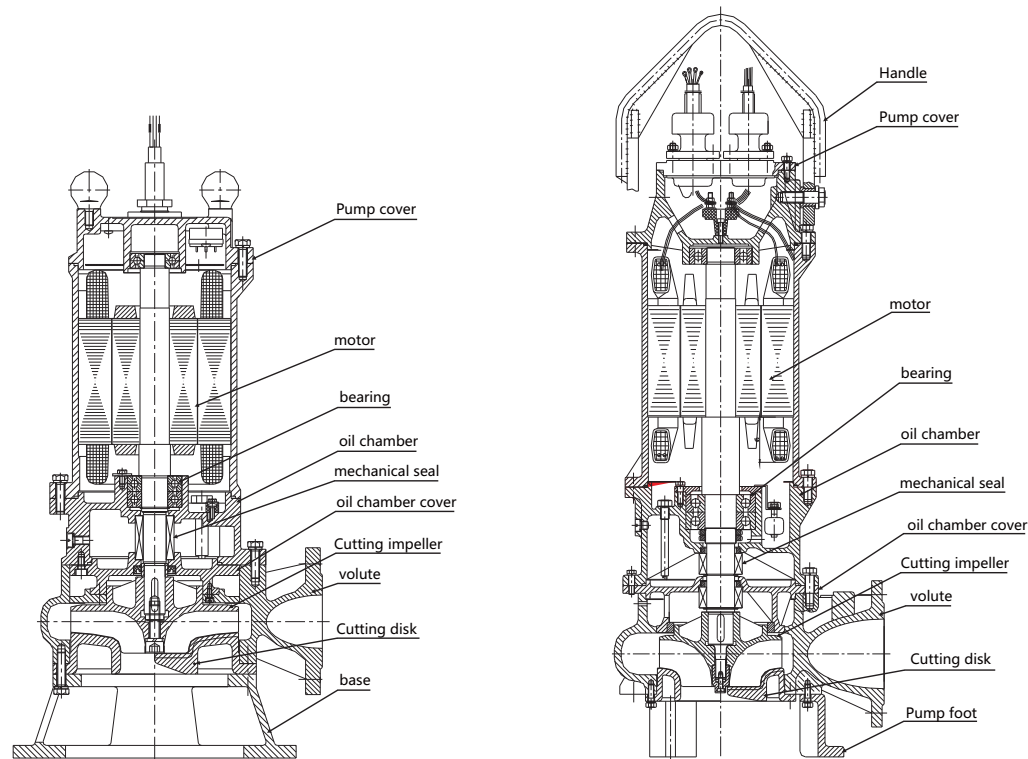

Material Configuration of Main Parts

Parts	Pump body	Cutting disk	Impeller	Motor Cover	Shaft	Mechanical Seal Components			
						Motor side friction pair	Pump side friction pair	spring	Rubber components
Materials	HT200	high Cr alloy roller	ZG20Cr13	HT200	20Cr13	SiC / Graphite	TC / SiC	Stainless	Nitrile rubber (NBR)

Installation method

1. Automatic coupling installation (Z): The coupling device includes a guide rod, a guide rod frame, an outlet pipe seat and a coupling frame, and the pump and the pipe are connected, and the connection and disengagement of the pump and the pipe are made simple and easy without using the fastener; the pump of the same discharge port diameter can use the same Coupling device, see Figure 1
2. Fixed base type installation (P): It is inconvenient to repair after the pump is running. If the pipeline is sufficiently rigid, the anchor bolts may not be installed. See Figure 2.
3. Mobile type installation (Y、R): For emergency or repair, construction needs, the base can be connected to the hose or pipe to run, or the rigid drainage pipe can be used to suspend the pump, see Figure 3.

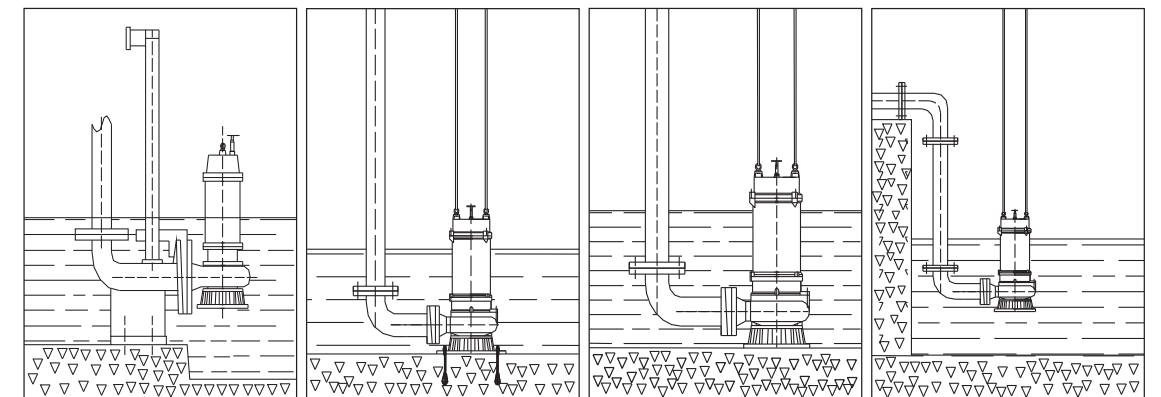

Figure1

Figure 2

Figure 3

Order remarks

1. When place order, please advise: series code, flow rate, head, speed, motor power, medium temperature, medium composition, medium density;
2. The motor cable provided are 9 meters, other lengths are required to be indicated when place order.
3. The complete supply parts are provided according to the determined installation method.
4. Options and spare parts are ordered separately by the user.

Chart for scope of supply

scope of supply	installation method					remarks	
	Wet type installation				Fixed dry type installation		
	Fixed type installation		mobile type installation				
	Automatic coupling type installation Z	Base type installation P11kW and above	The outlet diameter is not more than 150 and the motor power is ≤22Kw		Base type installation P11kW and above		
		Soft connector R	hard connector Y				
Complete standard supply	pump	<input type="checkbox"/>	<input type="checkbox"/>	<input type="checkbox"/>	<input type="checkbox"/>	<input type="checkbox"/>	
	Elbow joint (1pcs/set)				<input type="checkbox"/>		
	Hose bending joint (1pcs/set)			<input type="checkbox"/>			
	Automatic coupling	<input type="checkbox"/>					
	(Suction bend 1pcs/set)					<input type="checkbox"/>	
	base seat (1pcs/set)		<input type="checkbox"/>	<input type="checkbox"/>	<input type="checkbox"/>	<input type="checkbox"/>	<input type="checkbox"/>
Optional parts	electrical control cabinet	<input type="checkbox"/>	<input type="checkbox"/>	<input type="checkbox"/>	<input type="checkbox"/>	<input type="checkbox"/>	
	Elbow joint		<input type="checkbox"/>			<input type="checkbox"/>	
	Cone tube	<input type="checkbox"/>	<input type="checkbox"/>		<input type="checkbox"/>	<input type="checkbox"/>	
	Trash rack	<input type="checkbox"/>	<input type="checkbox"/>	<input type="checkbox"/>	<input type="checkbox"/>	<input type="checkbox"/>	customization
	start/stop device	<input type="checkbox"/>	<input type="checkbox"/>	<input type="checkbox"/>	<input type="checkbox"/>	<input type="checkbox"/>	customization
	Rectangular gate	<input type="checkbox"/>	<input type="checkbox"/>	<input type="checkbox"/>	<input type="checkbox"/>	<input type="checkbox"/>	customization
	terminal box	<input type="checkbox"/>	<input type="checkbox"/>	<input type="checkbox"/>	<input type="checkbox"/>	<input type="checkbox"/>	
	(liquid) Float switch	<input type="checkbox"/>	<input type="checkbox"/>	<input type="checkbox"/>	<input type="checkbox"/>	<input type="checkbox"/>	
	gate valve/butterfly valve	<input type="checkbox"/>	<input type="checkbox"/>	<input type="checkbox"/>	<input type="checkbox"/>	<input type="checkbox"/>	
	check valve	<input type="checkbox"/>	<input type="checkbox"/>	<input type="checkbox"/>	<input type="checkbox"/>	<input type="checkbox"/>	
	anchor bolt	<input type="checkbox"/>	<input type="checkbox"/>			<input type="checkbox"/>	
	hose			<input type="checkbox"/>			
	Stainless steel wire rope and rope clamp for lifting pump	<input type="checkbox"/>	<input type="checkbox"/>	<input type="checkbox"/>	<input type="checkbox"/>	<input type="checkbox"/>	
	spare part	impeller	<input type="checkbox"/>	<input type="checkbox"/>	<input type="checkbox"/>	<input type="checkbox"/>	<input type="checkbox"/>
seal ring		<input type="checkbox"/>	<input type="checkbox"/>	<input type="checkbox"/>	<input type="checkbox"/>	<input type="checkbox"/>	
bearing		<input type="checkbox"/>	<input type="checkbox"/>	<input type="checkbox"/>	<input type="checkbox"/>	<input type="checkbox"/>	
mechanical seal		<input type="checkbox"/>	<input type="checkbox"/>	<input type="checkbox"/>	<input type="checkbox"/>	<input type="checkbox"/>	
O-ring		<input type="checkbox"/>	<input type="checkbox"/>	<input type="checkbox"/>	<input type="checkbox"/>	<input type="checkbox"/>	

Coupling installation dimension drawing

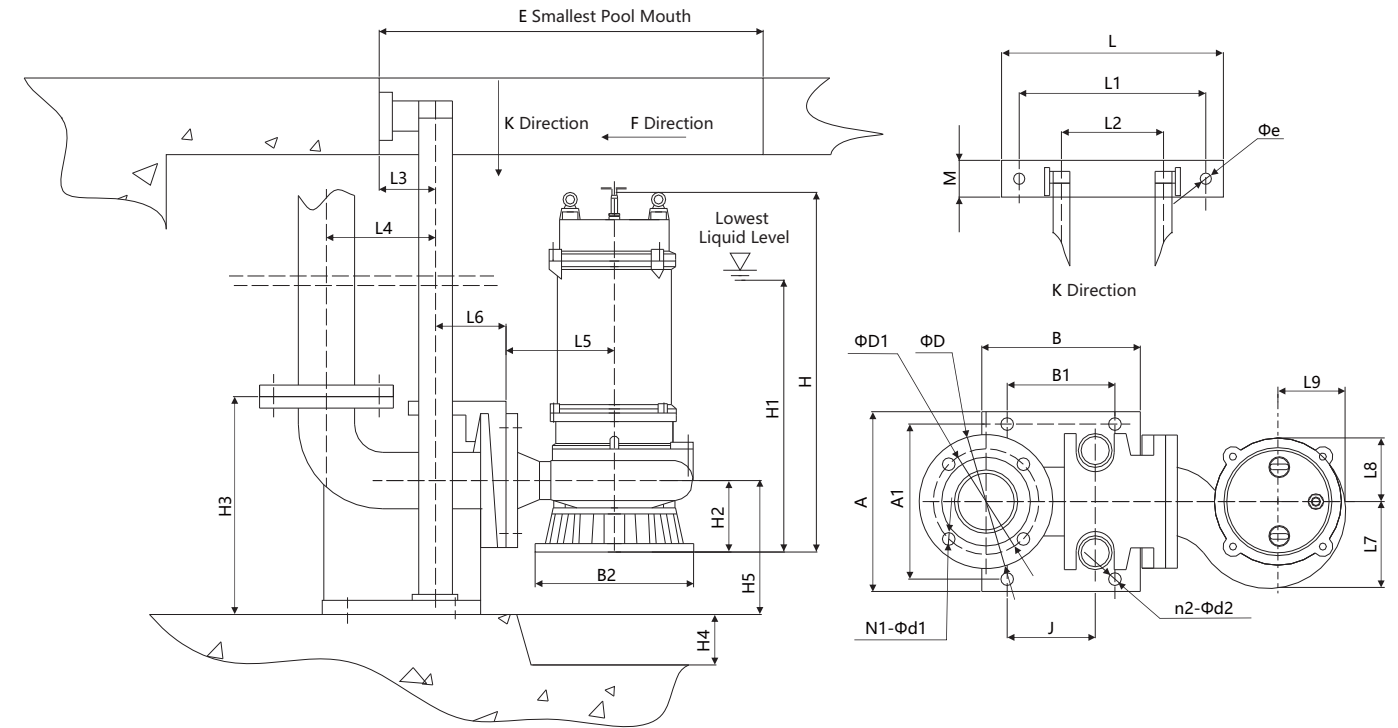

Coupling parts dimension

S/N	Model	Flange connection dimension			Coupled base seat size						H3	H4	H5	L	L1	L2	M	Φe	L3	L4	L6	E
		D	D1	N1-Φd1	A	A1	B	B1	J	n2-Φd2												
1	40WQ	130	100	4 - Φ14	108	65	138	68	68	4 - Φ16	195	100	120	225	185	70	35	Φ14	65	125	85	550 x 550
2	50WQ	140	110	4 - Φ14	197	168	208	130	120	4 - Φ16	250	100	165	265	215	110	42	Φ14	65	135	90	550 x 550
3	65WQ	160	130	4 - Φ14	238	190	252	155	135	4 - Φ16	265	100	170	280	235	125	50	Φ14	70	185	85	650 x 600
4	80WQ	190	150	4 - Φ19	255	220	225	153	125	4 - Φ18	310	100	190	315	265	145	53	Φ14	80	155	100	650 x 600
5	100WQ	210	170	4 - Φ19	293	265	258	175	140	4 - Φ18	350	100	235	365	305	170	55	Φ14	100	200	110	650 x 600
6	150WQ	265	225	8 - Φ19	400	300	410	300	210	4 - Φ25	485	150	305	410	260	285	60	Φ14	100	300	190	1300x900

Cutting pump outline and movable installation dimension

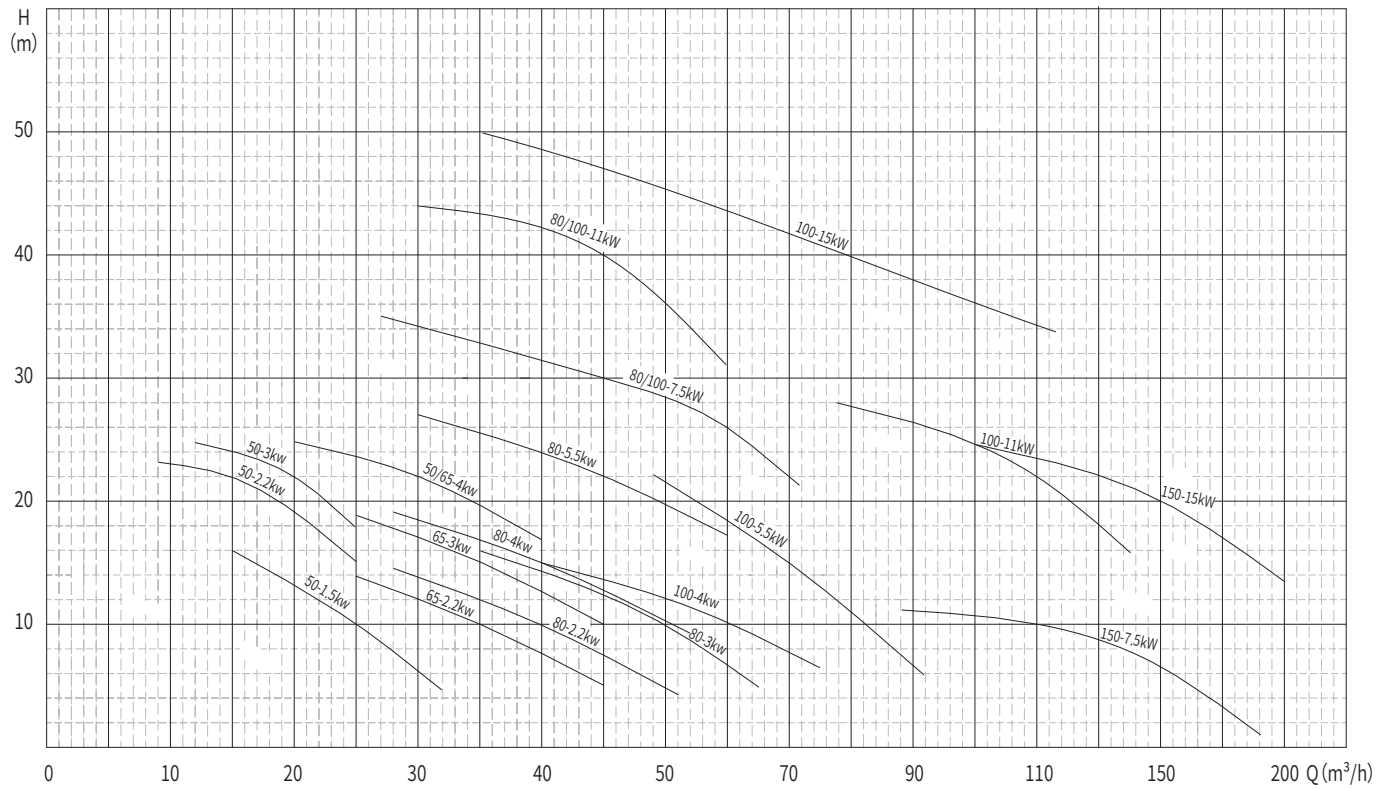
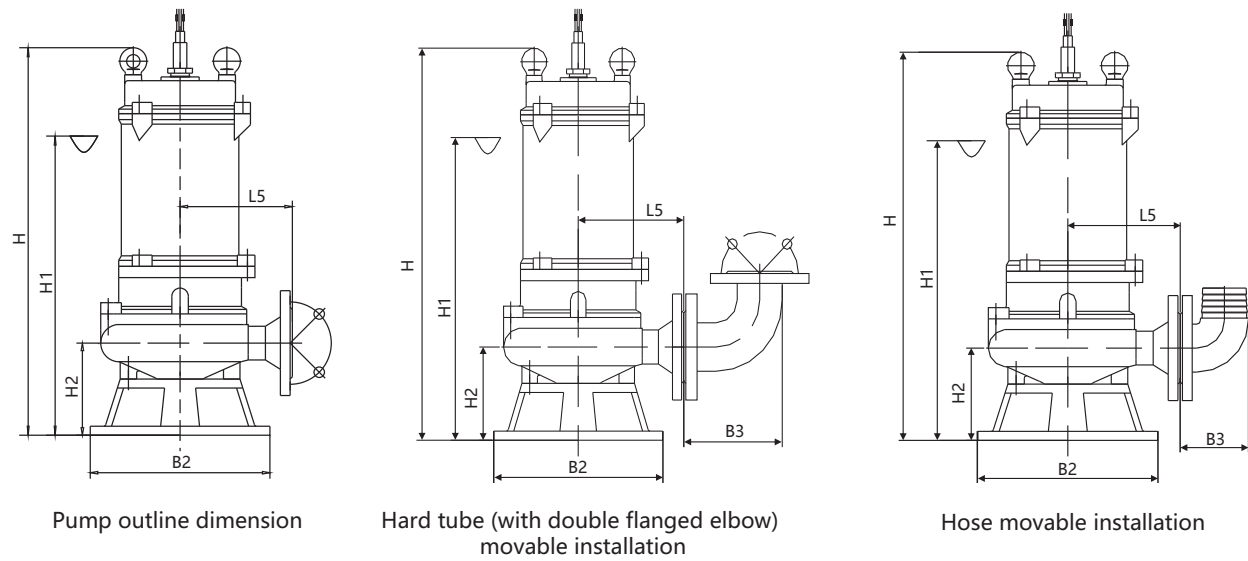

Performance data and size sheet

S/N	model	pump outlet diameter mm	flow rate Q m³/h	head H m	RPM n	power P kw	Pump efficiency η %	Motor efficiency η %	Motor power factor cosφ	Motor rated current A	the maximum diameter of the particles d50 mm	dimension (mm)									weight kg
												H	H1	H2	B2	B3	L5	L7	L8	L9	
1	50DSWQ10-10-0.75QX	50	10	10	2950	0.75	58	65.0	0.82	1.8	25	470	350	110	200	190	135	85	75	80	26
2	50DSWQ15-8-1.1QX		15	8		1.1	57	69.0	0.83	2.6	25	470	350	110	200	190	135	95	80	88	28
3	50DSWQ25-10-1.5QX		25	10		1.5	66	72.0	0.83	3.5	25	510	390	135	240	190	155	105	90	95	31
4	50DSWQ15-20-2.2QX		15	20		2.2	56	73.0	0.84	4.9	25	540	430	130	270	190	160	110	102	106	37
5	50DSWQ20-22-3QX		20	22		3	61	78.5	0.87	6.4	25	560	450	130	270	190	160	120	110	115	43
6	50DSWQ30-22-4QX		30	22		4	65	79.0	0.87	8.1	25	620	510	154	320	190	160	125	115	120	61
7	65DSWQ35-10-2.2QX	65	35	10		2.2	63	73.0	0.84	4.9	30	544	405	138	240	240	165	112	92	100	43
8	65DSWQ30-15-3QX		30	15		3	65	78.5	0.87	6.4	25	567	429	140	240	240	170	121	96	108	46
9	65DSWQ30-22-4QX		30	22		4	65	79.5	0.87	8.1	25	620	510	154	320	200	190	125	115	120	64
10	80DSWQ40-10-2.2QX	80	40	10		2.2	69	73.0	0.84	4.9	30	544	405	138	240	240	165	112	92	100	43
11	80DSWQ50-10-3QX		50	10		3	68	78.5	0.87	6.4	30	567	429	140	240	240	170	121	96	108	46
12	80DSWQ40-15-4QX		40	15		4	65	79.5	0.87	8.1	30	660	550	160	320	240	200	140	126	132	74
13	80DSWQ45-22-5.5QX		45	22		5.5	69	81.5	0.88	11	30	660	550	160	320	240	200	140	126	132	75
14	80DSWQ45-30-7.5QX		45	30		7.5	67	82.5	0.88	15	30	653	515	145	320	300	235	152	130	152	108
15	80DSWQ45-40-11QX		45	40		11	65	83.0	0.88	22	30	980	750	148	360	240	235	150	132	145	110
16	100DSWQ55-12-4QX	100	55	12		4	70	79.5	0.87	8.1	30	630	520	160	320	300	185	135	110	122	65
17	100DSWQ70-15-5.5QX		70	15		5.5	71	81.5	0.88	11	30	690	570	170	320	300	235	150	130	140	102
18	100DSWQ45-30-7.5QX		45	30		7.5	67	82.5	0.88	15	30	653	525	145	320	300	235	152	130	152	108
19	100DSWQ110-22-11QX		110	22		11	73	83.0	0.88	22	35	1000	750	153	354	300	250	152	145	152	120
20	100DSWQ70-40-15QX		70	40		15	68	84.0	0.88	29	30	1005	765	155	350	300	250	160	150	155	123
21	150DSWQ130-8-7.5QX		150	130		8	7.5	72	82.5	0.88	15	40	701	560	174	370	400	260	175	150	160
22	150DSWQ150-20-15QX	150		20		15	74	84.0	0.88	29	40	1250	890	250	400	400	300	180	155	170	135

Scope of Applications

- It is used to transport wastewater containing long fibers and solid particles; urban and rural domestic sewage and biogas digesters; sewage risers and other fields.
- Medium temperature ≤ 40 °C, volume ratio of solid phase in the medium <2%, medium PH: 4-10; minimum operating level: see installation dimension ▽ corresponds to H1.

Technical Explanations

1. Model definition:

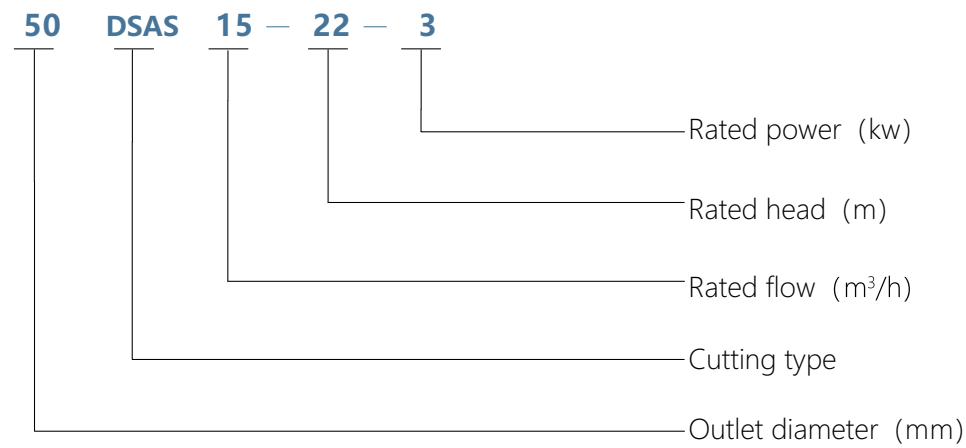

The rated voltage of the motor: 380v (the motor can be 220v at 1.5kw and below), the rated frequency is 50Hz.

Installation Method

1. Automatic coupling installation type: the coupling device includes a guide rod, a guide rod frame, an outlet pipe seat and a coupling frame, connecting the pump and the pipeline, without the fasteners, making the connection and disengagement of the pump and the pipeline simple and easy; the same discharge Caliber pumps can use the same coupling.
2. Mobile installation type: for emergency or repair, construction needs, support the hose or pipe with the base support, or use the rigid enough drainage management to suspend the pump.

When Place Order, Please Advise

1. Please specify when ordering: series model, flow, head, speed, motor power, medium temperature, medium composition, medium density, installation method, discharge diameter;
2. The motor cable is provided at 10 meters. When other lengths are required, the order must be indicated;
3. The complete set of supply parts is provided according to the determined installation method;
4. Options and spare parts are ordered separately by the user.

Performance Data Sheet

Model	Flow rate	Head	Speed	Power	Current	Dimension (mm)			
	m ³ /h	m	rpm	kW	A	H	H1	B2	D2
40DSAS7-7-0.75	7	7	2860	0.75	2	425	335	230	200
40DSAS7-10-1.1	7	10	2860	1.1	2.8	425	335	230	200
40DSAS7-15-1.5	7	15	2860	1.5	4	470	380	270	240
40DSAS7-20-2.2	7	20	2860	2.2	6	500	410	270	240
40DSAS7-25-3	7	25	2860	3	6.5	520	430	270	240
50DSAS7-7-0.75	7	7	2860	0.75	2	425	335	230	200
50DSAS10-7-1.1	10	7	2860	1.1	2.8	425	335	230	200
50DSAS10-10-1.5	10	10	2860	1.5	4	470	380	270	240
50DSAS10-15-2.2	10	15	2860	2.2	6	500	410	270	240
50DSAS10-22-3	10	22	2860	3	6.5	520	430	270	240
65DSAS20-7-2.2	20	7	2860	2.2	6	500	410	270	240
65DSAS20-10-3	20	10	2860	3	6.5	520	430	270	240